

**RECEIVED**

OCT 7 1983

WATER RESOURCES DEPT.  
SALEM, OREGON

T. 30 S., R. 3 E., W.M.

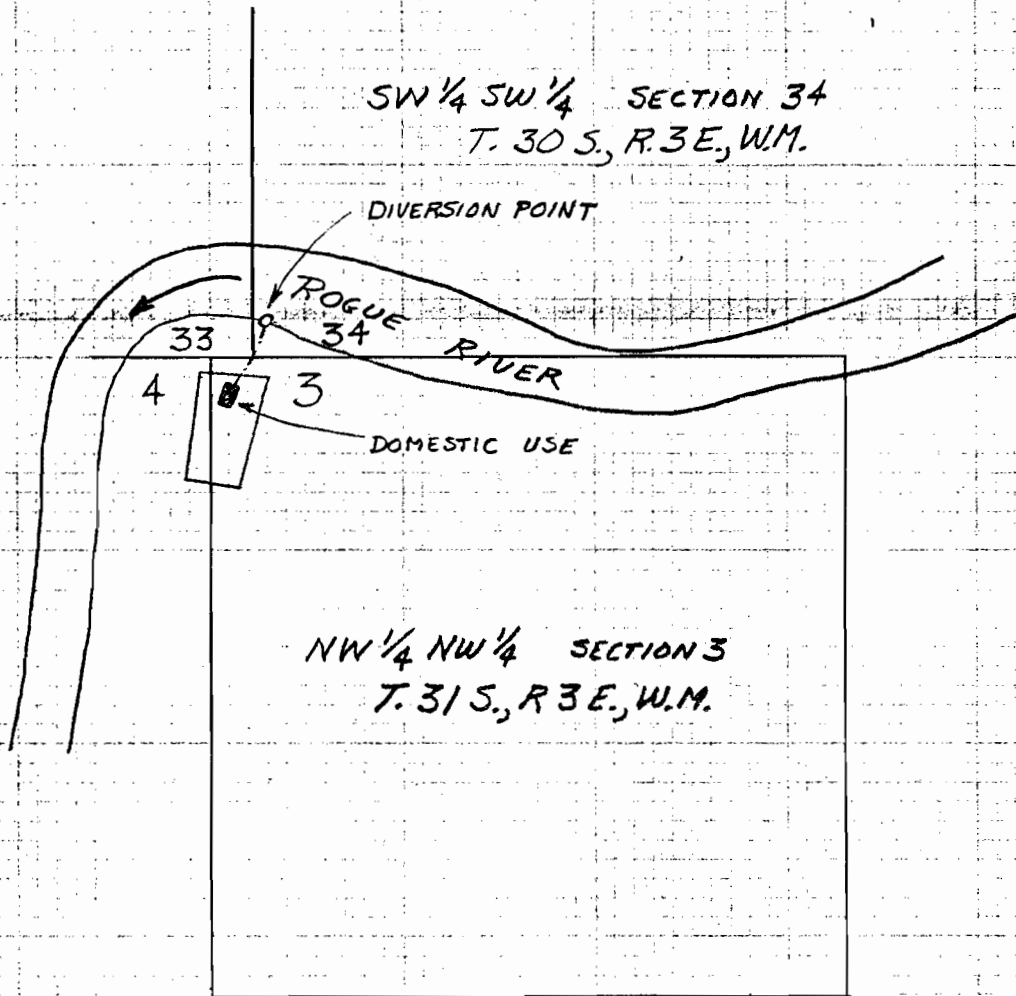

10-5-83

DIV. PT. LOCATED: 70' N. AND 20' E. FROM  
SW CORNER. SECTION 34 T. 30 S., R. 3 E. W.M.

MAP TO ACCOMPANY APPLICATION FOR DOMESTIC USE  
FROM ROGUE RIVER FOR JEAN TAYLOR &/OR SCOTT TAYLOR

SCALE 1" = 400'

Application No. 67431

Permit No. 47907