

T. 3 N., R. 1 W., W.M.

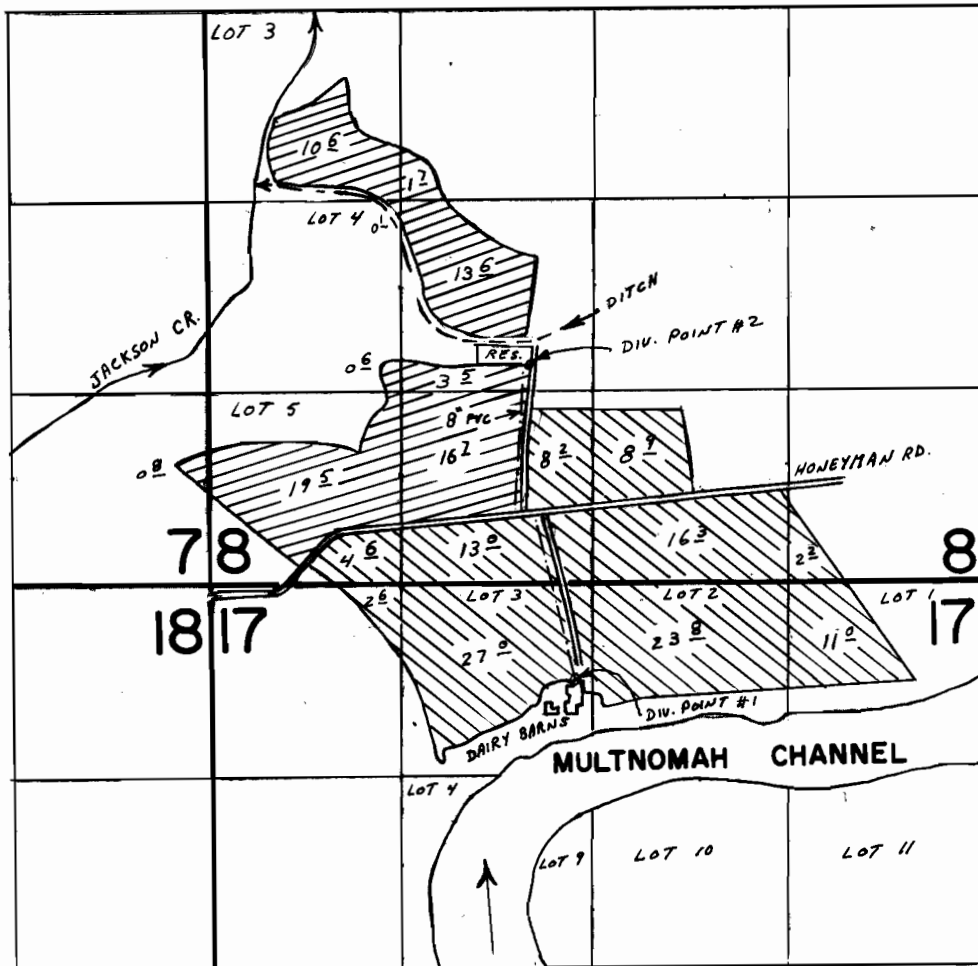

SCALE 1" = 1320'

DIV. POINT #1 : 650' S. & 2500' E FROM NW CORNER SECTION 17
 DIV. POINT #2 : 1500' N. & 2700' E FROM NW CORNER SECTION 17



PRIMARY



SUPPLEMENTAL

FINAL PROOF SURVEY

UNDER

R-63941

R-8505

Application No. **63942** Permit No. **47049**

IN NAME OF

CASE LOQS

Surveyed **AUG. 25, 1988**, by **Z. SALEH**

AAA-000
 AAA-001
 12-22-88 Z.F.S.