

T.8S., R.2W., W. M.

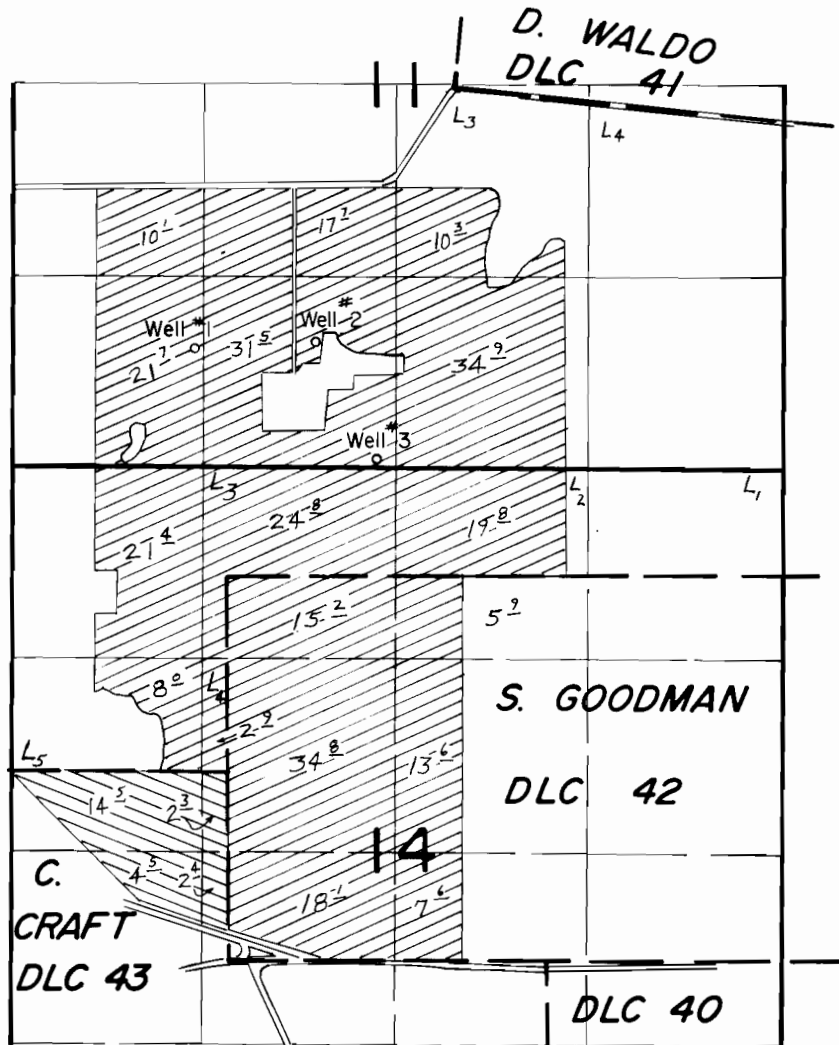

Wells Loc.: *1- 1800' S. & 1850' W., *2- 1750' S. & 950' W.,
 *3- 2550' S. & 520' W.; all from SW Cor. WALDO DLC 41.

Scale: 1" = 1320'

FINAL PROOF SURVEY

UNDER

 Well 3; Supplemental

Application No. G-11389 Permit No. G-10594

 Wells 1, 2, & 3, Primary

IN NAME OF

CHARLES D. WAVRA

Surveyed Sept. 25, 1986, by T. Warren

41047-178-119 R

12/8/86 TMW