

T.33S., R.2E., W.M.

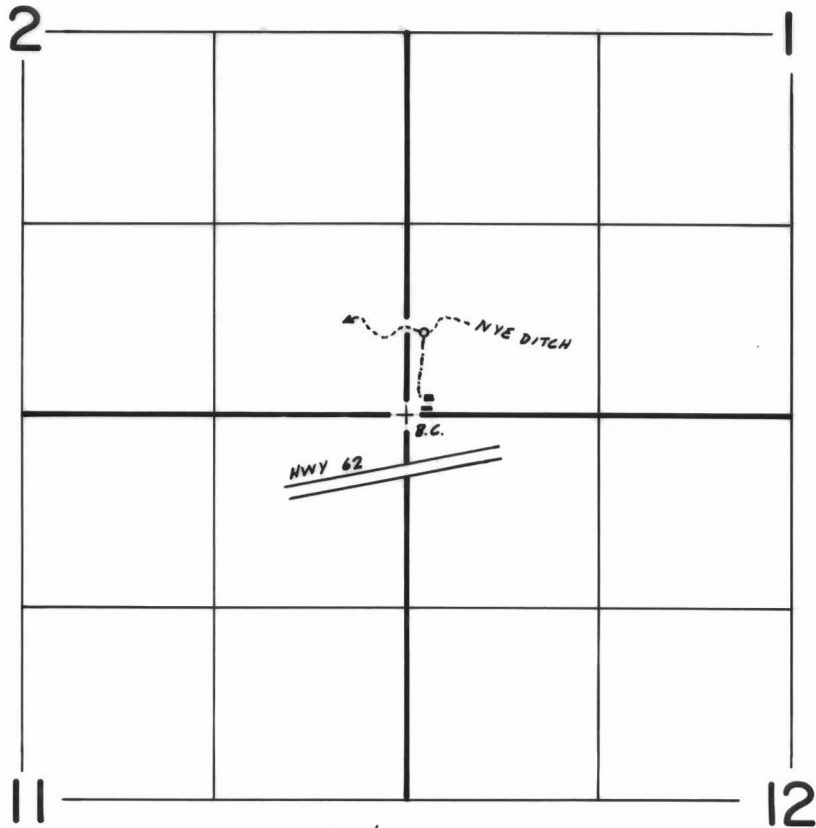

MILL CREEK DIV. PT. : 1060' N & 2690' E FROM SW COR. SEC. 28.  
T. 32S, R. 3E, W.M.

Scale 1" = 1320'

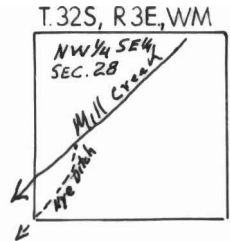

**FINAL PROOF SURVEY**  
UNDER

Application No. 58527 Permit No. 44169.....  
IN NAME OF

D. V. A.

Surveyed Oct. 28, 1985, by B.S. JAMES.....