

T. 30S., R. 2W., W.M.

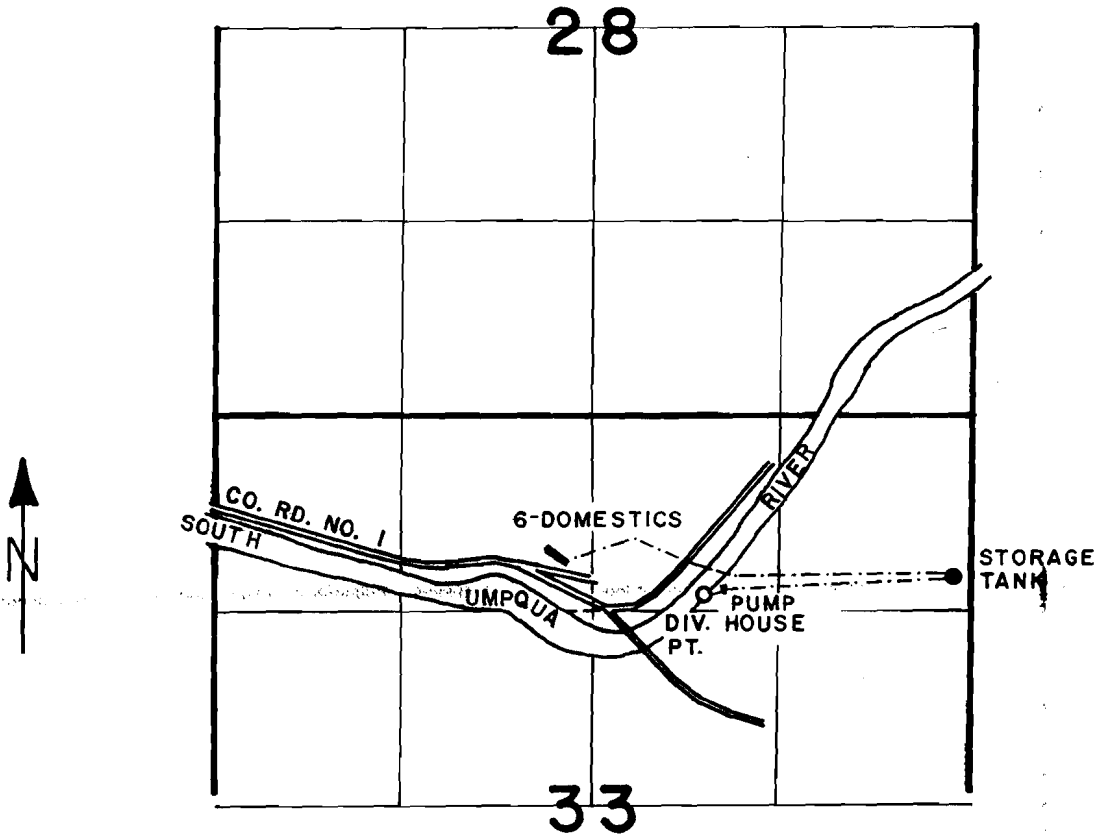

DIV. PT. IS 1220' SOUTH AND 1840' WEST FROM NE CORNER SEC. 33

SCALE: 4" = 1 MILE

FINAL PROOF SURVEY UNDER

Application No. 68233. Permit No. 49176
IN NAME OF

UNITED STATES, NATIONAL FOREST

Surveyed AUG. 5, 1987, by J. M. SCHMORDE