

T. 2S., R. 1W., W.M.

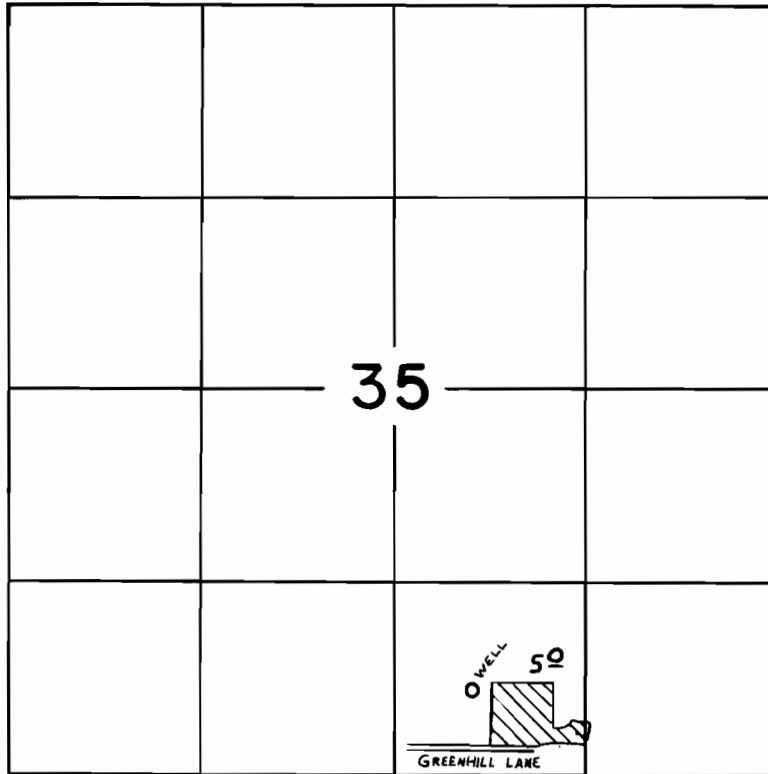

WELL Loc: 580' N, 2100' W. fr. S.E. Cor. Sec. 35.

SCALE: 1" = 1320'

**FINAL PROOF SURVEY**  
UNDER

Application No. G-9919... Permit No. G-9092...  
IN NAME OF

**CLOYD EDWARD WILLEY**

Surveyed NOV 9 1983, by L. TOLL