

# FINAL PROOF SURVEY

UNDER

Application No's 50323 Permit No's 37994 *64630*  
 58060 43772 *64631*

TRANSFER NO'S: 2791 *64632*  
 3906 *64725*  
 3907 *64735*  
 3908 *64727*

IN NAME OF

POWAY CITRUS CO.

Surveyed SEPT. 16, 1979, by *AC Bixson*

DIVERSION POINTS LOCATED:

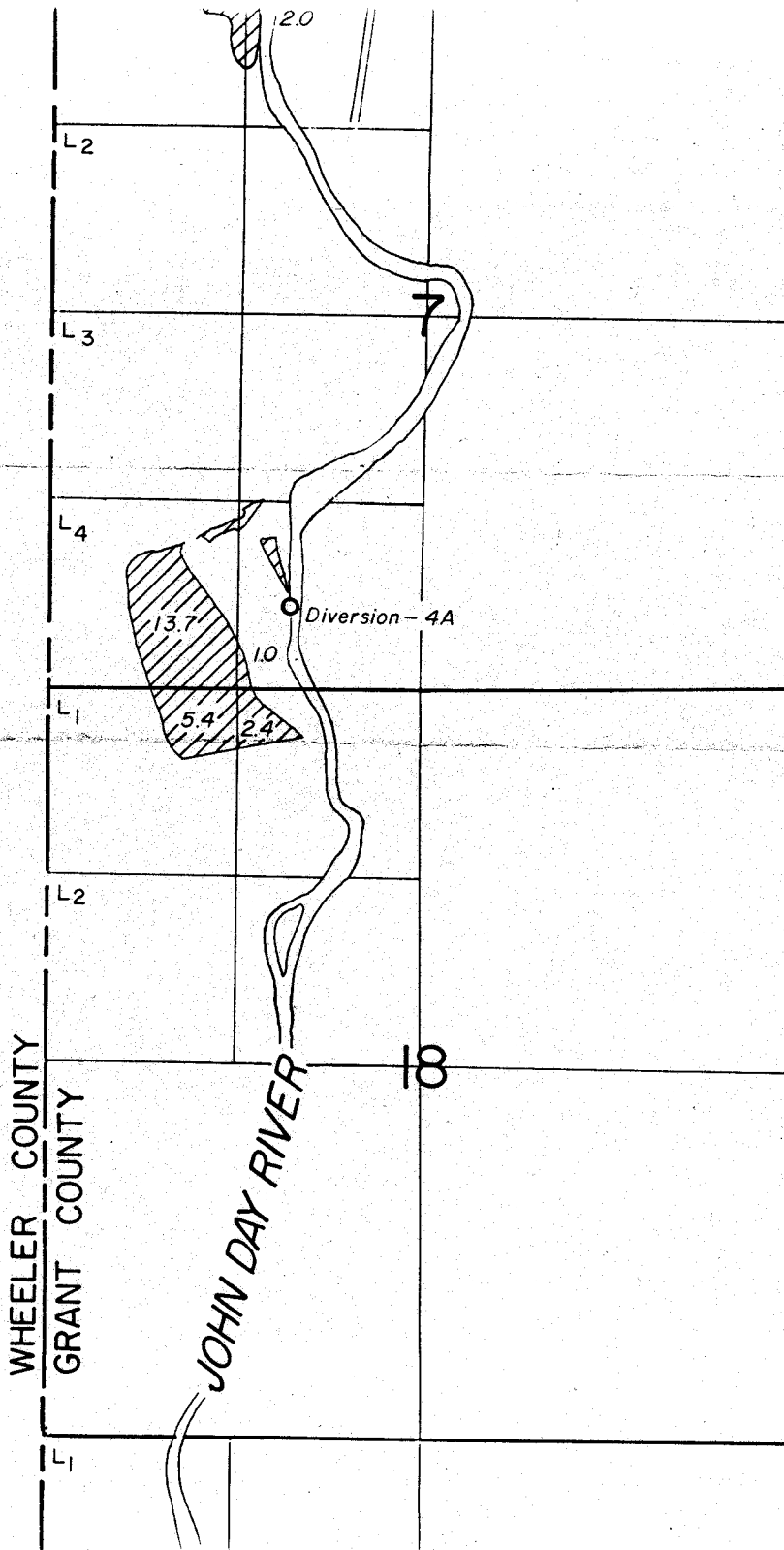

- No. 1 - 430' S. & 390' E. from W. 1/4 Cor. Sec. 30
  - No. 2 - 2550' S. & 220' E. from W. 1/4 Cor. Sec. 30
  - No. 3 - 1670' S. & 1140' E. from NW Cor. Sec. 31
  - No. 4A - 580' N. & 1690' E. from SW Cor. Sec. 7
  - No. 4B - 330' S. & 1430' E. from SW Cor. Sec. 7
  - No. 4C - 1050' N. & 1870' E. from NW Cor. Sec. 7
  - No. 5 - 150' S. & 1600' E. from SW Cor. Sec. 7
  - No. 6B - 3620' N. & 1340' E. from SW Cor. Sec. 19
  - No. 7 - 520' S. & 660' E. from NW Cor. Sec. 6
- ALL FROM NW Cor. Sec. 7  
 ABOVE WITHIN T. 10S., R. 26E., W.M.  
 WITHIN T. 11S., R. 26E., W.M.



A

DIVERSION POINTS LOCATED:

- No. 1 - 430' S. & 390' E. from W. 1/4 Cor. Sec. 30
- No. 2 - 2550' S. & 220' E. from W. 1/4 Cor. Sec. 30
- No. 3 - 1670' S. & 1140' E. from NW Cor. Sec. 31
- No. 4A - 580' N. & 1690' E. from SW Cor. Sec. 7
- No. 4B - 330' S. & 1430' E.
- No. 4C - 1050' N. & 1870' E. } ALL FROM NW Cor. Sec. 7
- No. 5 - 150' S. & 1600' E.
- No. 6B - 3620' N. & 1340' E. from SW Cor. Sec. 19
- ABOVE WITHIN T. 10S., R. 26E., W.M.
- No. 7 - 520' S. & 660' E. from NW Cor. Sec. 6
- WITHIN T. 11S., R. 26E., W.M.

-  PERMIT 37994
-  PERMIT 43772

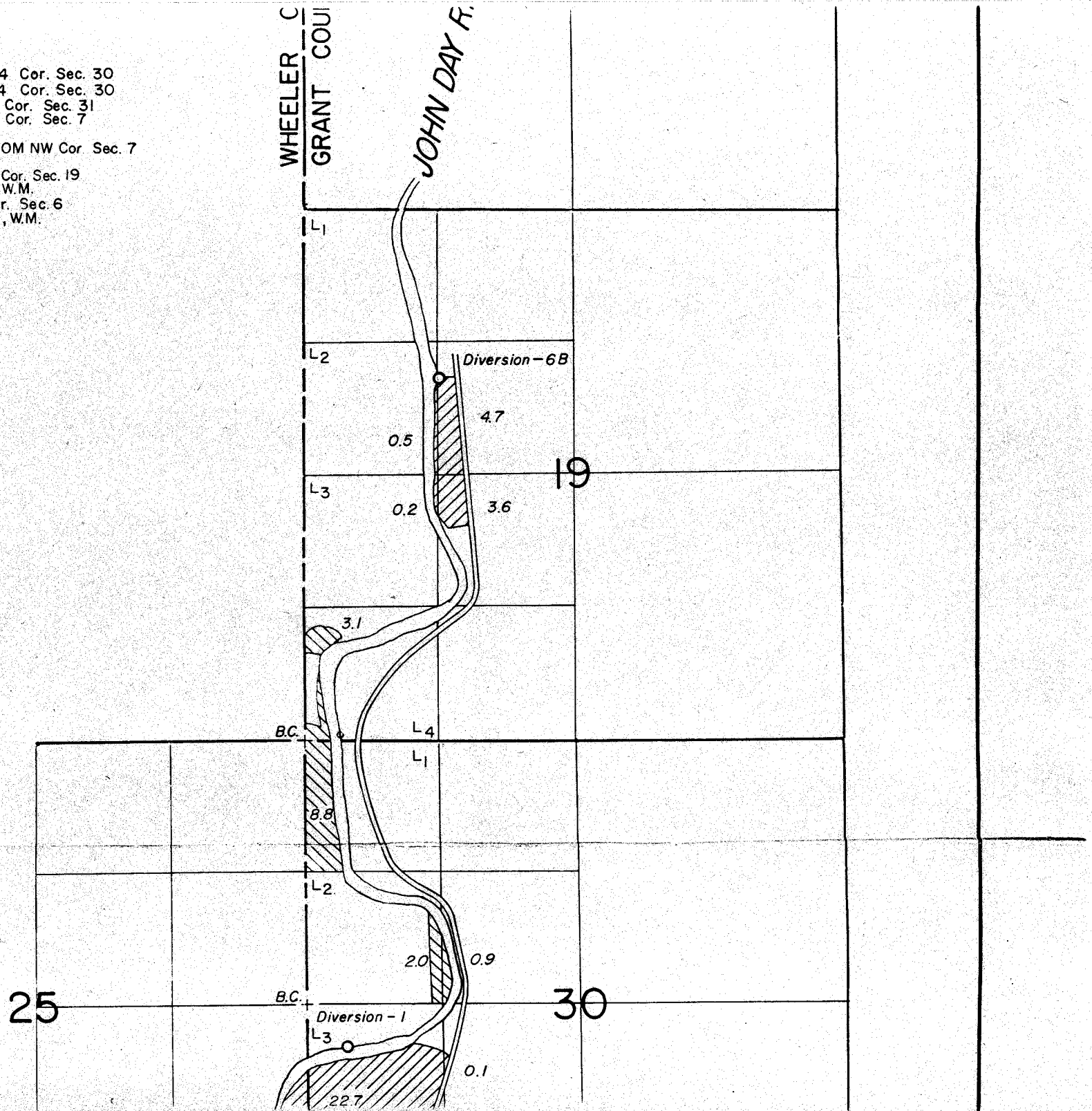

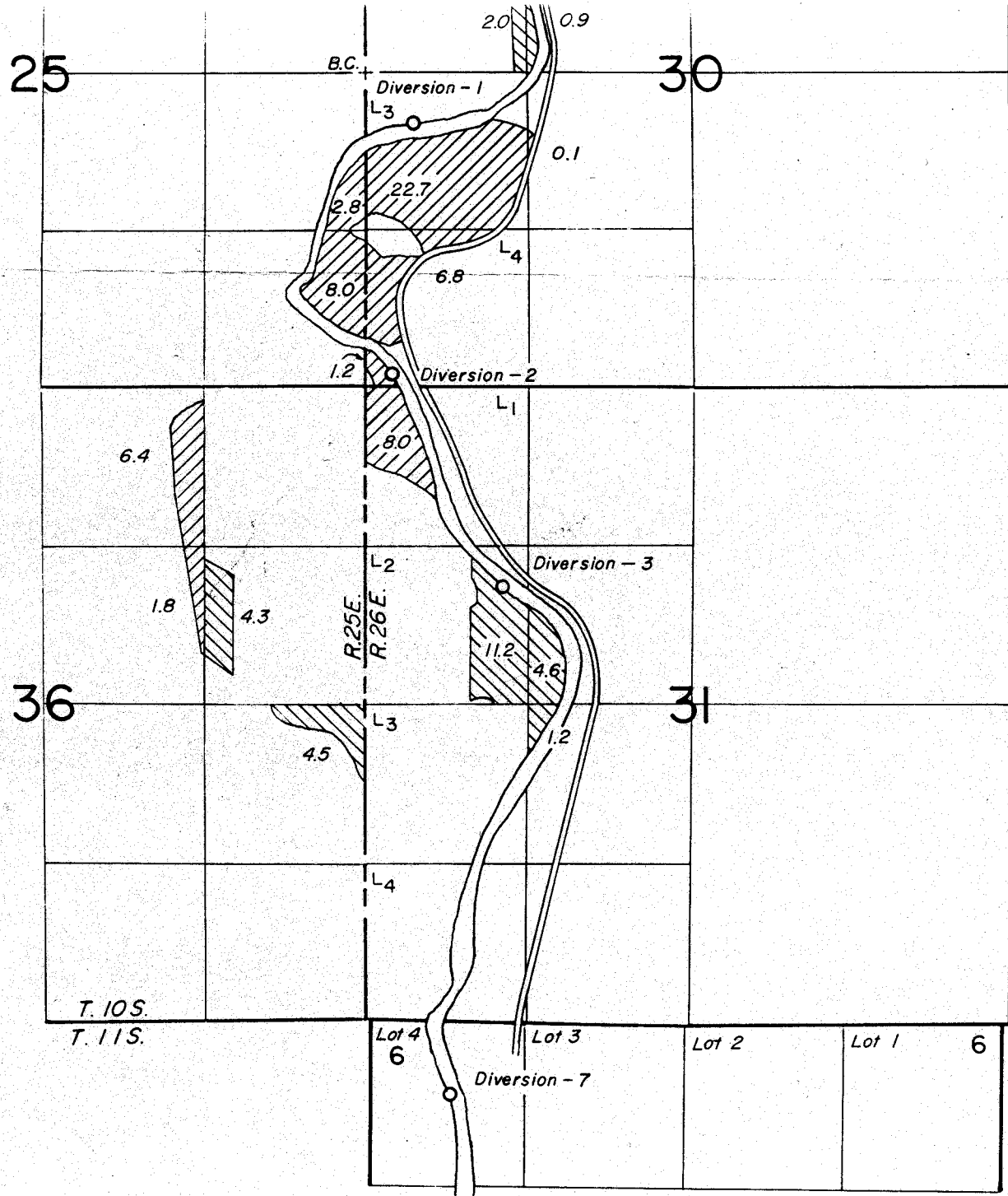

TOWNSHIPS 10&11 SOUTH, RANGE 25&26 EAST, W.M.

