

T. 7S., R. 1W., W.M.

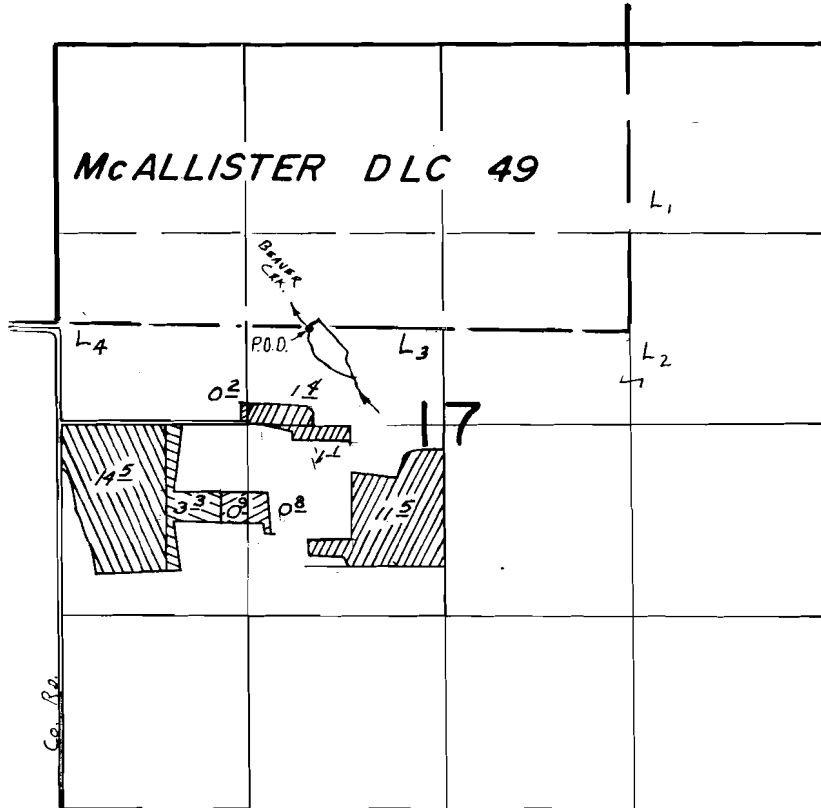

P.O.D. Loc.: 670' N. & 1750' E. from W. 1/4 Cor. Sec. 17.

Scale: 1" = 1320'

FINAL PROOF SURVEY

UNDER

58923	44264	
60437	45035	
62035	45907	
Application No. 68732	Permit No. 49652	

IN NAME OF

ELDON & MARY KUENZI

Surveyed JUNE 6, 1984, by Ben Bishop.....
& Sept. 23 1986 by T. Warren

copy

41047-278-132 D

12/5/86 TMW