

T. 1N., R. 4W., W.M.

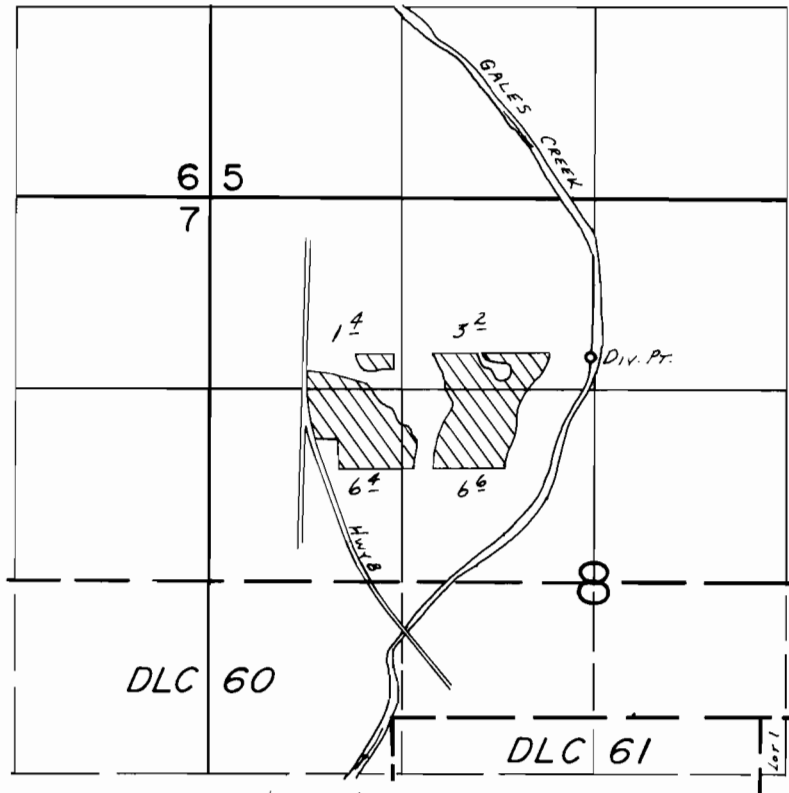

DIV. PT. LOC.: 1100'S. & 2620' E. FROM NW COR. SEC. 8.

SCALE: 1" = 1320'

FINAL PROOF SURVEY UNDER

Application No. 59712... Permit No. 44809.....
IN NAME OF

.....MARIE J. VANDEWATER.....

Surveyed Sept. 3..... 19.86, by B.W. BISHOP....

1-22-87
RWB

41067-178-52L