

T. 30S., R. 5W., W.M.

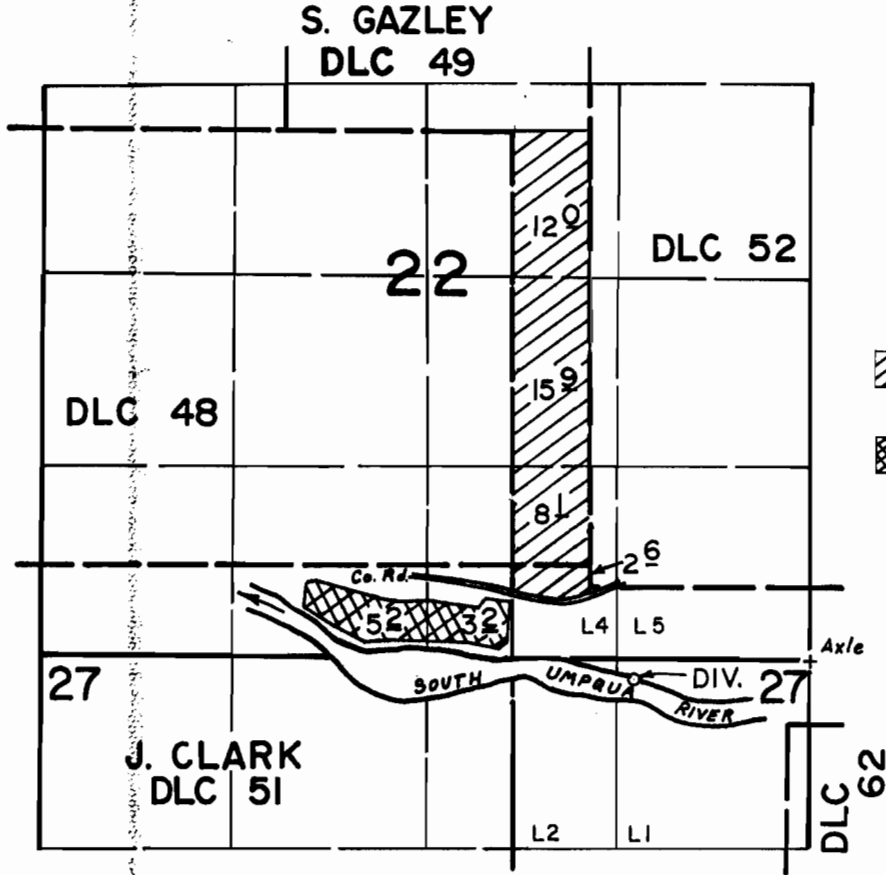

DIV. LOCATION: 150' S. & 1200' W. from S.E. CORNER
SEC. 22

SCALE: 4" = 1 mile

FINAL PROOF SURVEY
UNDER

Application No. ~~59717~~ 57872 Permit No. ~~44847~~ 43681
IN NAME OF

.....ARTHUR I. CUSTIS.....

Surveyed MAY...31.. 19.84, by *J.E. Cashim*.....