

T.26S., R.6W., W.M.

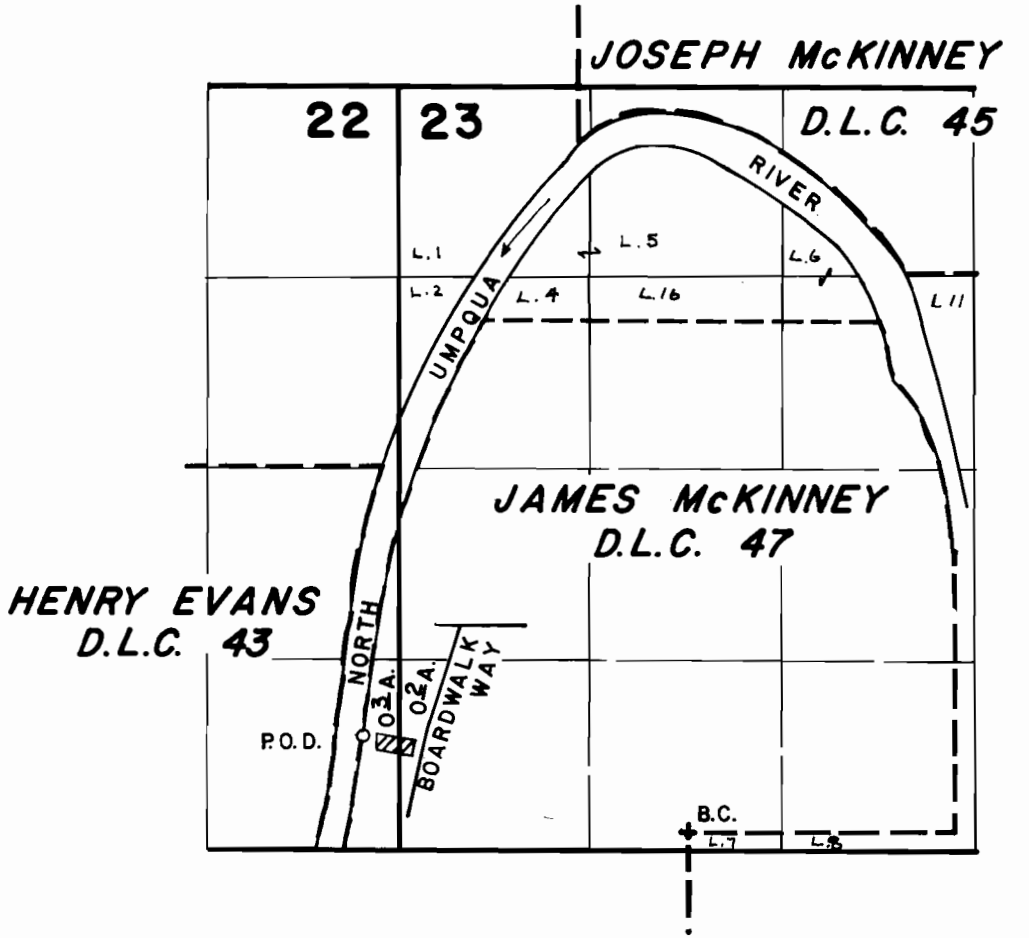

P.O.D. LOCATED 660' N. & 2240' W. FROM NW CORNER OF LOT 7

SCALE: 4" = 1 MILE



**FINAL PROOF SURVEY**

UNDER

Application No. 60944 Permit No. 45404  
IN NAME OF

ROBERT E. NEVIN

Surveyed MAY 2 1984, by L. E. CASHION