

RECEIVED

NOV 19 1989

PLANNING & SURVEYING
SALES

850 ft. east

NOTE:

No property corners were found. Property was located by apparent "lines of occupation" and witness by owner Robert N. Johnson.

SW 1/4 NE 1/4

690 ft. north



Scale: 1" = 100 ft.

Center of Section 16

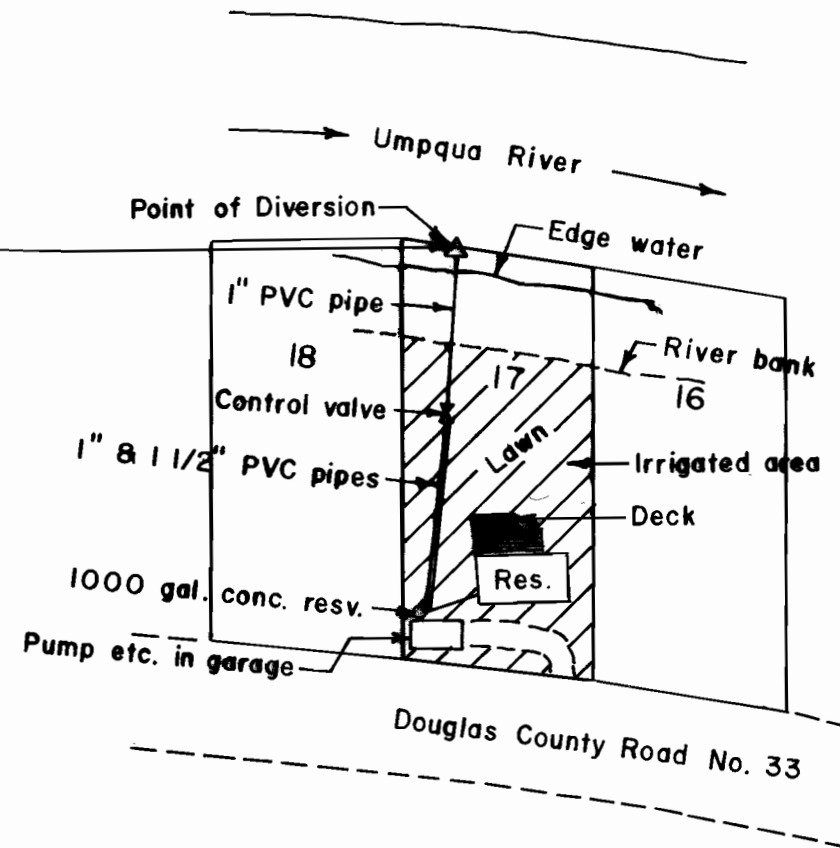

"Rasmussen Hole", a subdivision in Lots 4 & 5, Section 16, T 25 S, R 7 W, W. M., Douglas County, Oregon

FINAL PROOF SURVEY OF PERMIT TO APPROPRIATE THE PUBLIC WATERS IN THE SW 1/4 NE 1/4 OF SECTION 16, T 25 S, R 7 W, W. M., DOUGLAS COUNTY, OREGON

Application No. 69261

Permit No. 50149

For: Robert N. Johnson
P. O. Box 123
Perris, California 92370

By: Shaner Engineering, Inc.
P. O. Box 1430
Roseburg, Oregon 97470

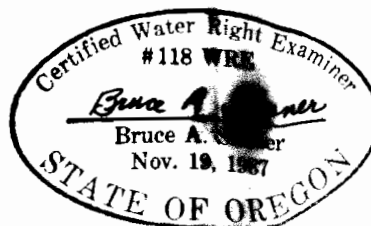

July 11, 1989