

AMACHER PARK WATER RIGHT MAP
T. 26 S. R. 6 W. S. 25

APPLICATION: 70142
PERMIT: 50874

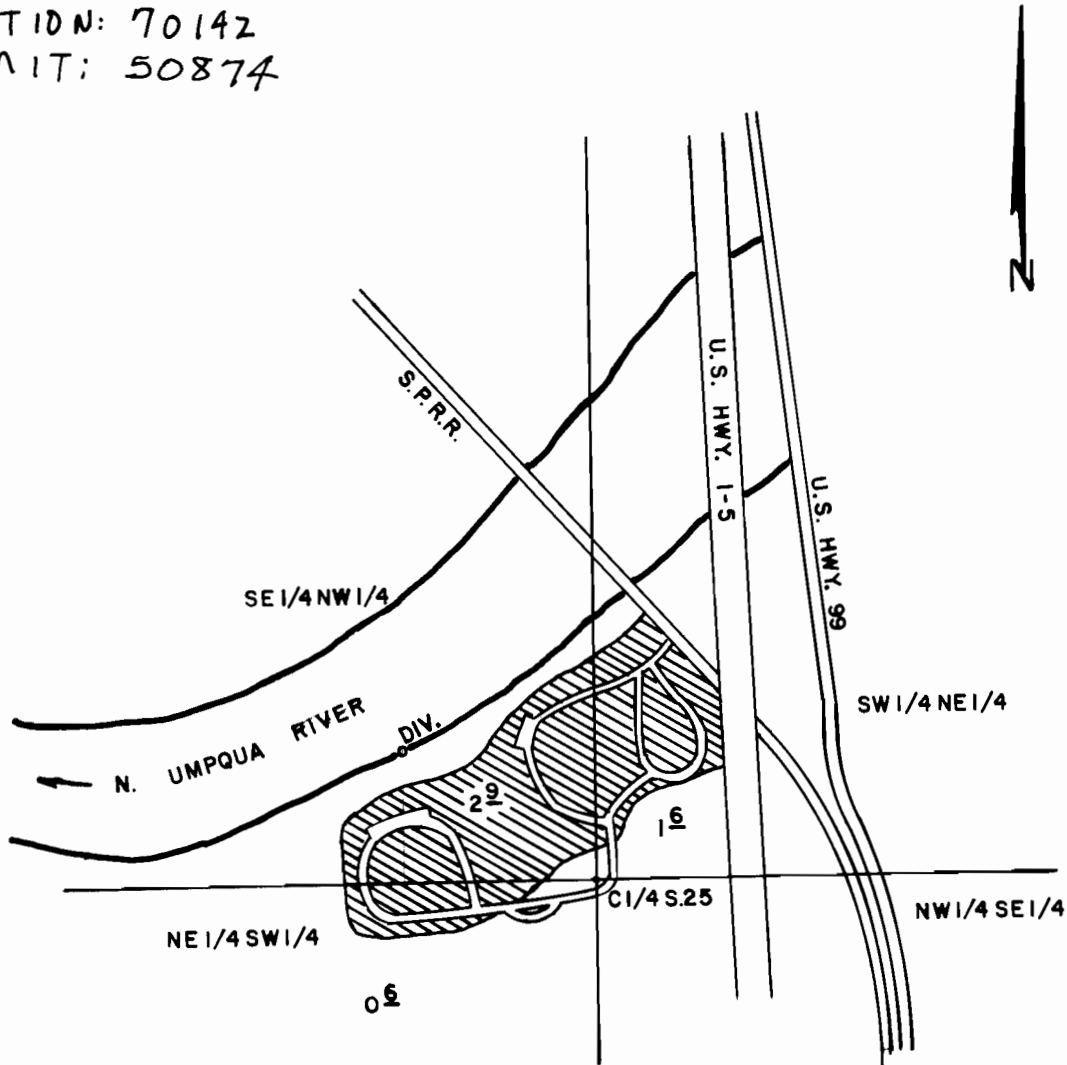

RECEIVED

NOV 11 1987

SCALE: 1" = 400'

DIV. = 280' N. & 410' W. FROM C1/4 S.25

WATER RESOURCES DEPT.
SALEM, OREGON

NOTE: THIS MAP IS INTENDED ONLY TO SHOW WATER RIGHT LOCATION AND IN NO WAY REFLECTS PROPERTY OWNERSHIPS OR BOUNDARIES.

