

T. 3 S., R. 1 W., W.M.

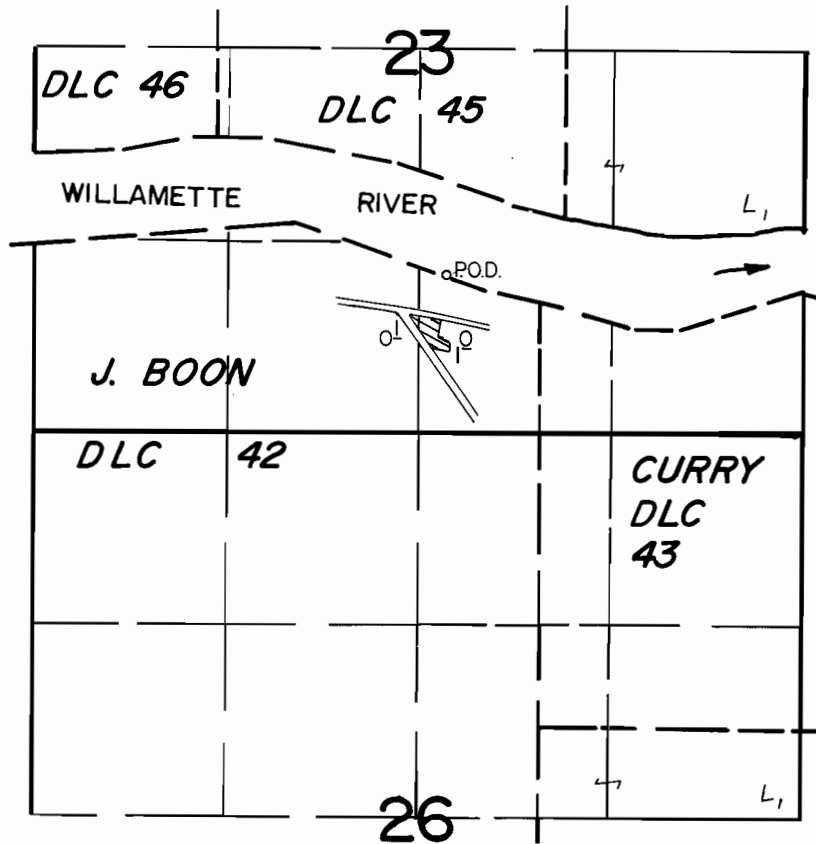

POB. Loc.: 210' N. & 650' W. from NE Cor. Boon DLC 42

Scale : 1" = 1320'

FINAL PROOF SURVEY UNDER

Application No. 61193..... Permit No. 45575.....
IN NAME OF

.....DAVID ALLEN WANOUS.....

Surveyed JULY 17, 1986., by T. Warren.....