

FINAL PROOF SURVEY MAP
 IN THE NAME OF ROBERT M. RITTER
 SECTION 6, T25S, R4W, W. M.

APPLICATION 69551 PERMIT 50447

RECEIVED

NOV 20 1957

WATER RESOURCES DEPT.
 OREGON



1 INCH = 1320 FEET

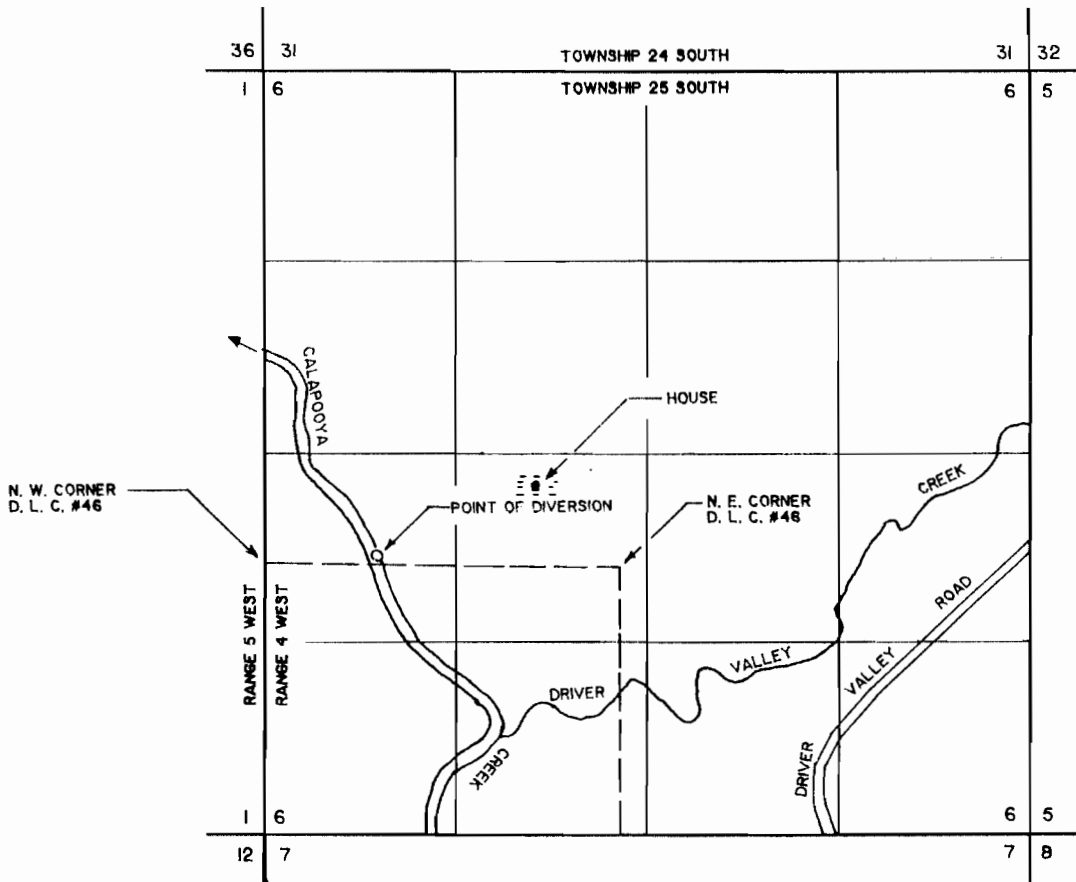

THE POINT OF DIVERSION IS LOCATED 3340 FEET SOUTH AND 1860 FEET WEST FROM THE NORTH 1/4 CORNER OF SECTION 6, BEING WITHIN THE NW1/4 OF THE SW1/4 OF SECTION 6, TOWNSHIP 25 SOUTH, RANGE 4 WEST, W. M.

THE PURPOSE OF THIS MAP IS TO IDENTIFY THE LOCATION OF THE WATER RIGHT. IT IS NOT INTENDED TO PROVIDE INFORMATION RELATIVE TO THE LOCATION OF PROPERTY OWNERSHIP BOUNDARY LINES.

