

T.17S.,R.1E.,W.M.

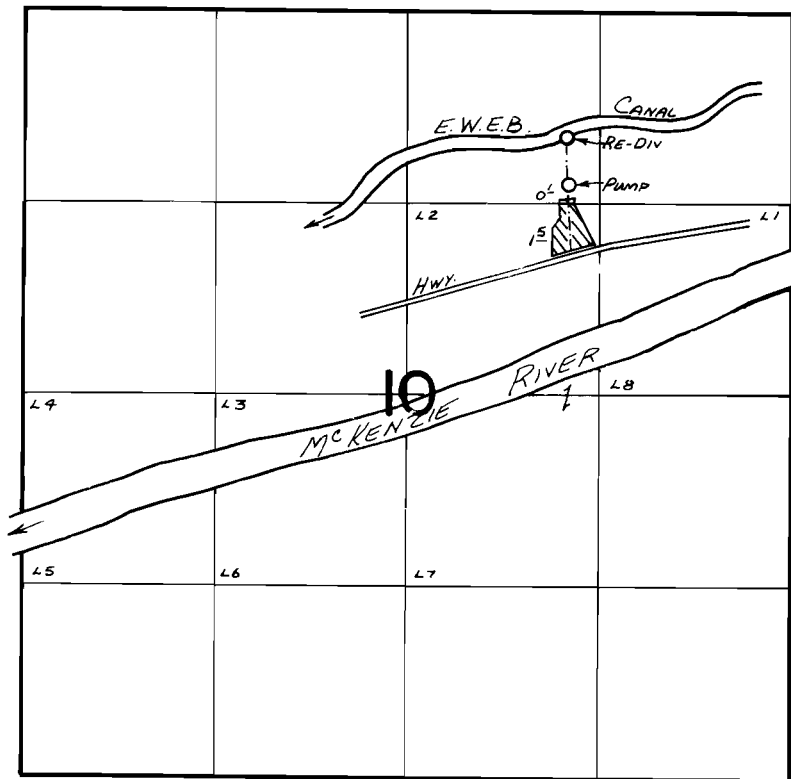

RE-PUMP P.O.D. LOCATED 860'S & 1530'W. FROM NE COR. SECTION 10

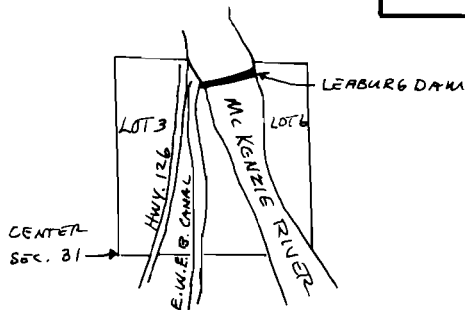

P.O.D. LOCATED 1150'N
AND 600'E FROM THE
CENTER OF SEC. 31,
T.16S., R.2E., W.M.

FINAL PROOF SURVEY UNDER

Application No. 52272... Permit No.39336....
IN NAME OF

TOMMY F. & DOROTHY F. ALLEN

Surveyed MAY...25.. 19..78, by ...C...L...HUGHES...
Aug 21 1981 S. C. BROWN