

# T.38S., R.4W., W.M.

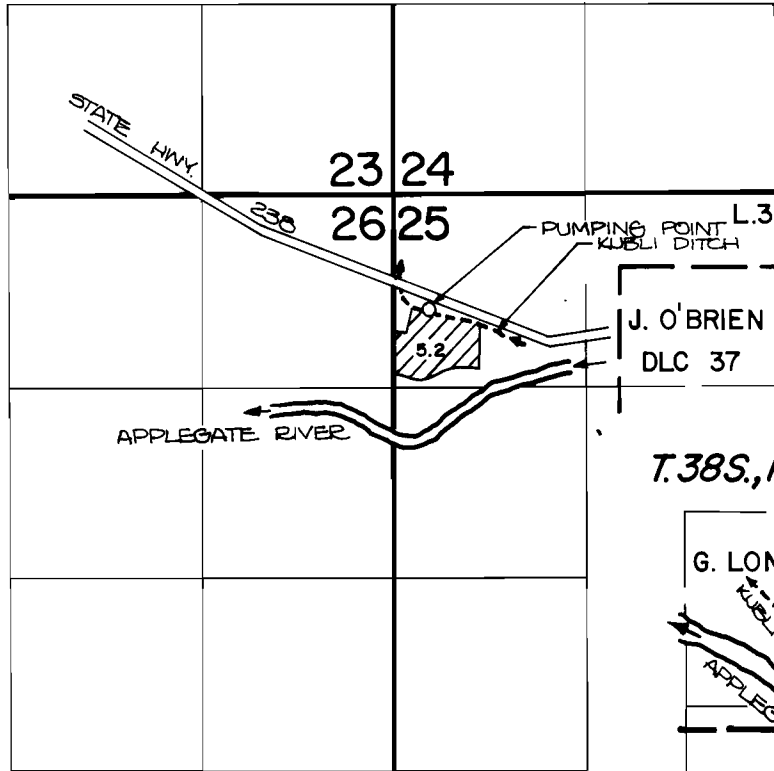

DIV. PT. IS LOCATED 2510' S. AND 3370' W. FROM THE N.E. CORNER OF G. LONG DLC 39 IN SEC. 30, T.38S., R.3W., W.M.

## T.38S., R.3W., W.M.

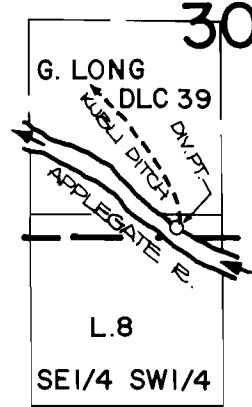

### FINAL PROOF SURVEY UNDER

Application No. 62196... Permit No. 46075...  
IN NAME OF

.....RALPH..... HENDRICKSON.....

Surveyed JULY 13 1983, by ...B... JAMES.....