

T.4N., R. 28E., W.M.

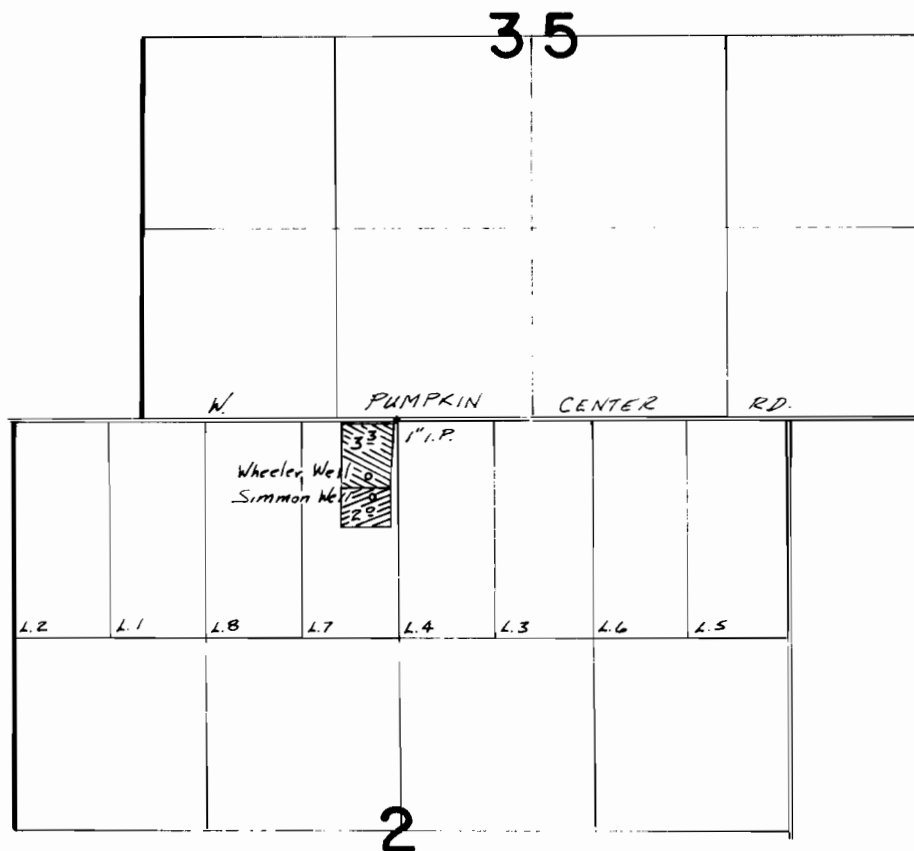

Wheeler Well Loc: 390' S. & 200' W. From N¹/₄ Cor. Sec. 2
Simmon Well Loc: 530' S. & 180' W. From N¹/₄ Cor. Sec. 2

FINAL PROOF SURVEY UNDER

Application No. G:7852. Permit No. G:7381.....
IN NAME OF

.....
Surveyed 3:29..... 1983, by V.L. Church.....