

# T. 2 S., R. 4 E., W.M.

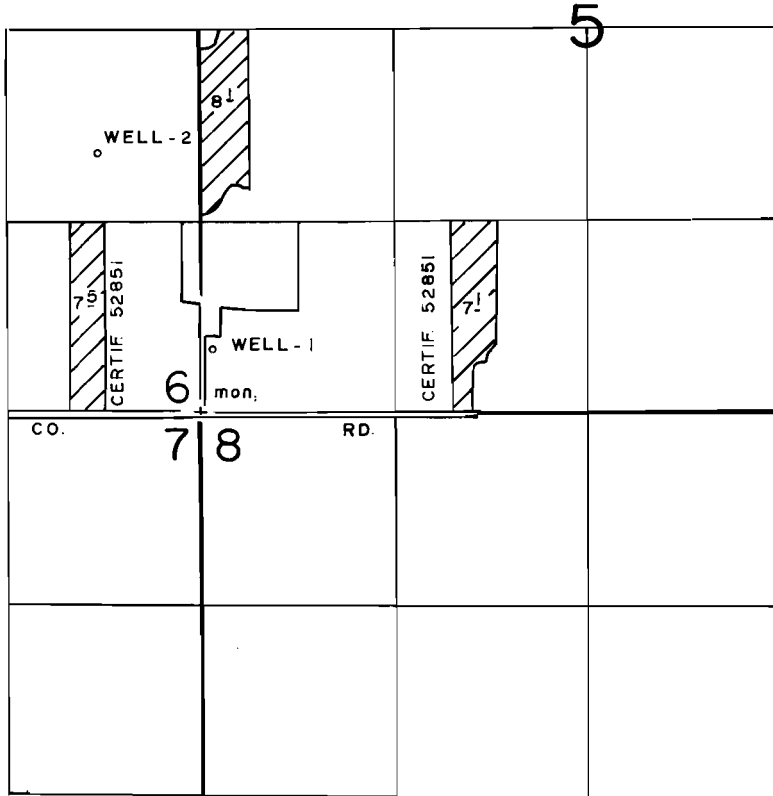

WELL-1 LOCATED 430'N. & 70'E. FROM SW. COR SEC. 5  
 WELL-2 LOCATED 1680'N. & 690'W. FROM SE COR. SEC. 5

## FINAL PROOF SURVEY UNDER

Application No. G-11356 Permit No. G-10484  
 IN NAME OF

ARNOLD MOORE

Surveyed JUNE 29 1990, by T. M. WARREN.