

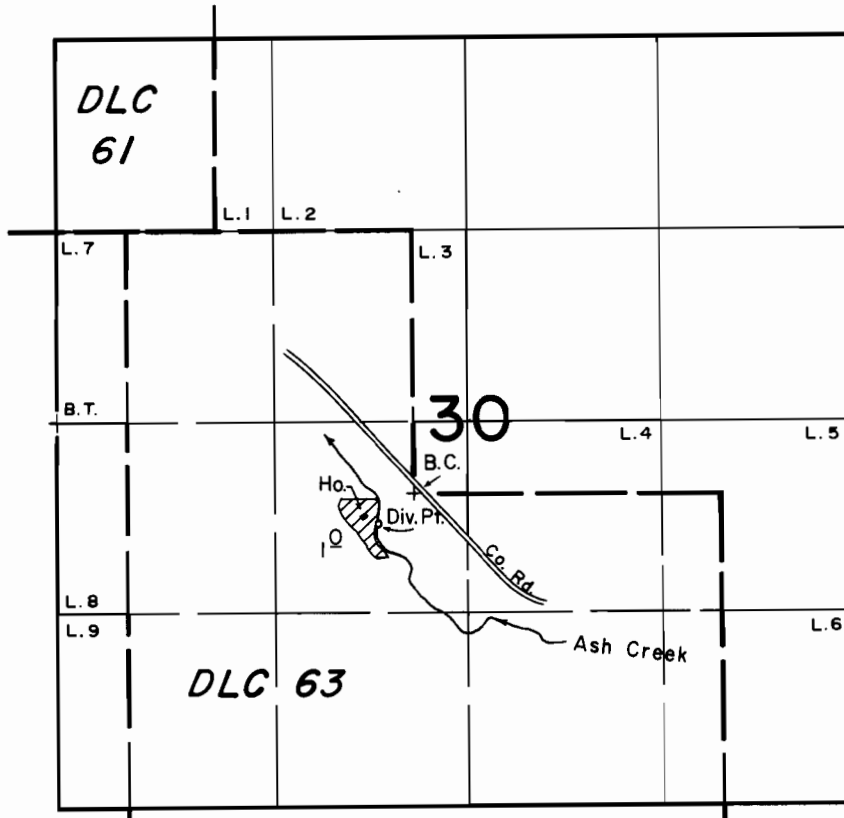

T. 30 S., R. 5 W., W.M.



DIV. PT. LOC.: 700' SOUTH AND 610' WEST FROM THE CENTER 1/4 COR. OF SEC. 30

SCALE: 1" = 1320'

FINAL PROOF SURVEY UNDER

Application No. 60312... Permit No. 45154.....

IN NAME OF

..... LEONARD D. SPRINGER

Surveyed APRIL 4, 1990, by B. S. JAMES.....