

43222  
R-7597  
65099  
65100

T. 36 S., R. 6 E., W.M.

Fourmile Crk. & Misc.

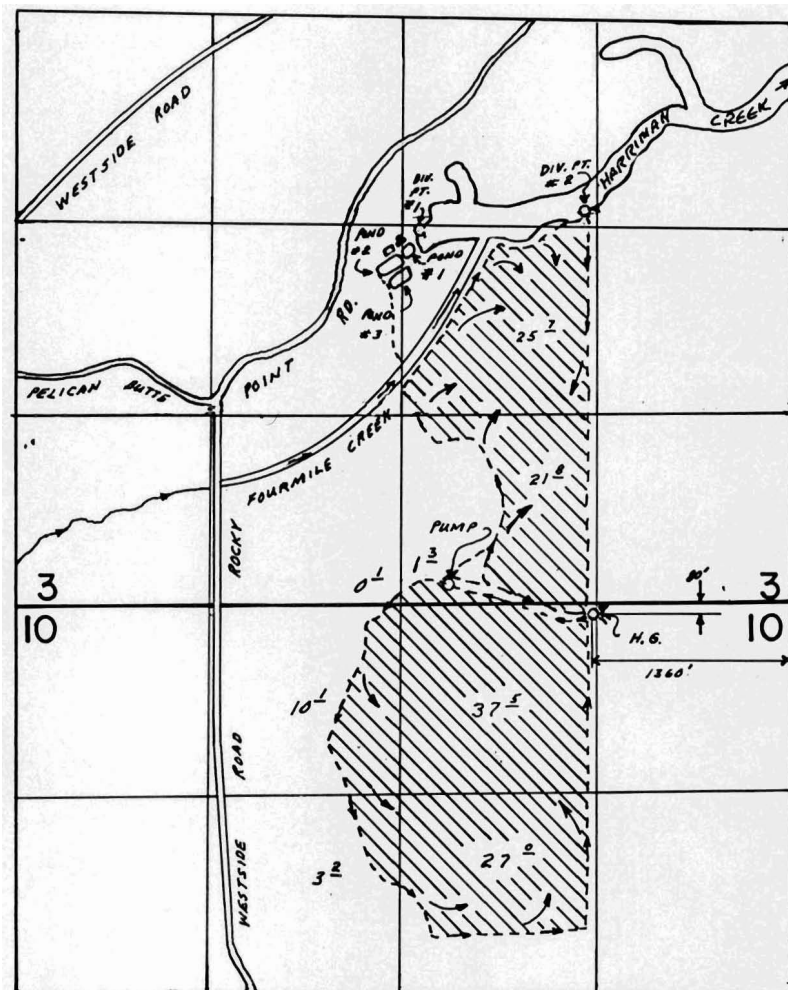

DIV. PT. 1 - 100' S & 2740' E  
DIV. PT. 2 - 80' N & 3900' E BOTH FROM E 1/4 COR SEC 3

SCALE: 1"=1320'

### FINAL PROOF SURVEY UNDER

R-57463                      R-7597  
Application No. 48758    Permit No. 43222.....  
IN NAME OF

ELDON V. & PEGGY M. STIVERS

Surveyed AUG. 19... 1987, by M. SCHMORDE...