

37900
65154

T. 1S. R. 24E. W.M.

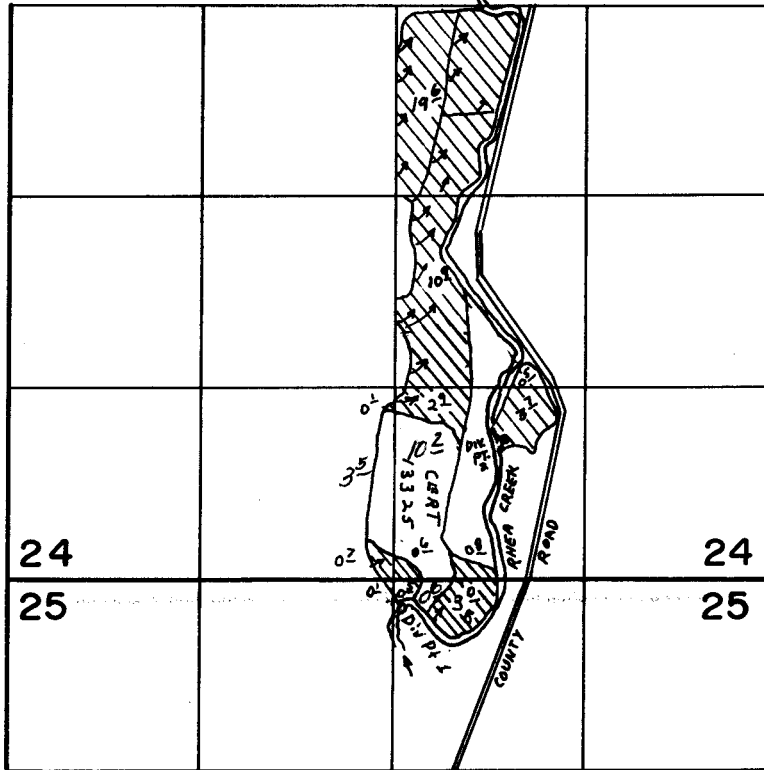

SCALE: 4" = 1 MILE



DIV. PT. 1 LOCATED 200 SOUTH AND 50 EAST FROM NORTH 1/4 COR. SEC. 25
 DIV. PT. 2 LOCATED 950 NORTH AND 750 EAST FROM SOUTH 1/4 COR. SEC. 24

FINAL PROOF SURVEY UNDER

Application No. 49924 Permit No. 37900
 IN NAME OF

R. W. BERGSTROM

Surveyed 6-23 1978, by R. BARWIN
 5-1 84 J.K. SAUTER

Revised 2-14-90 DM
 JFF-265 6-5-84 JS