

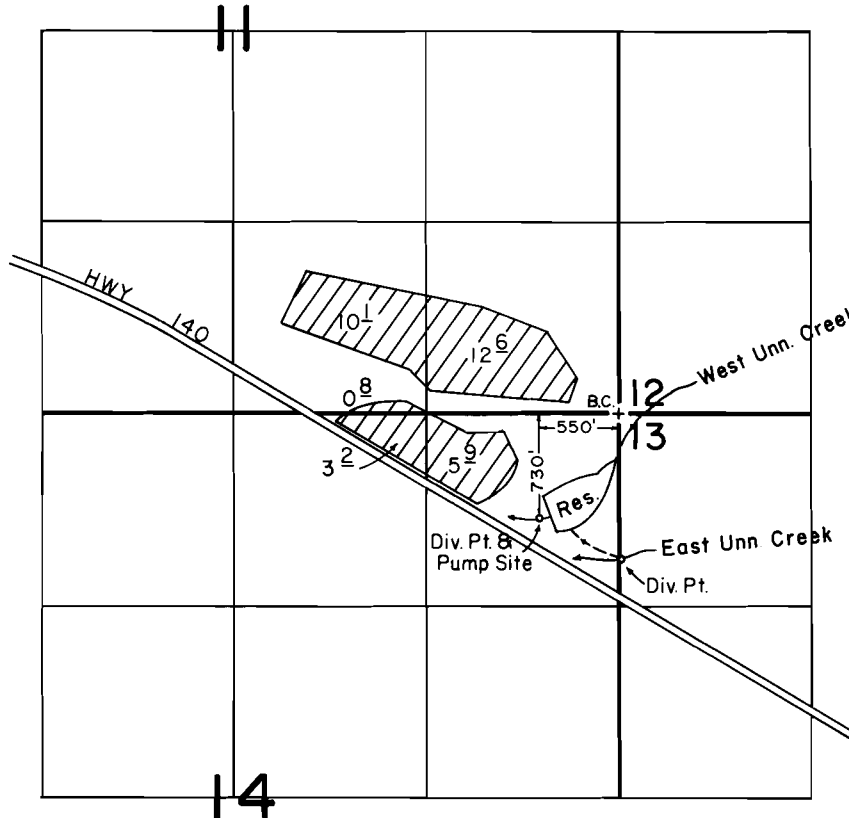

T. 36 S., R. 1 E., W.M.



DIV. PT. LOC.: East Unn. Creek - 1000' S. & 10' E. FROM THE NW CORNER OF SECTION 13.

SCALE: 1" = 1320'

FINAL PROOF SURVEY UNDER

R-49104 R-5977

Application No. 49105... Permit No. 36830...
IN NAME OF

KENNETH OWEN

Surveyed JULY 11 1989, by B. S. JAMES