

G-8544
65239

T. 1 N., R. 20 E. W. M.

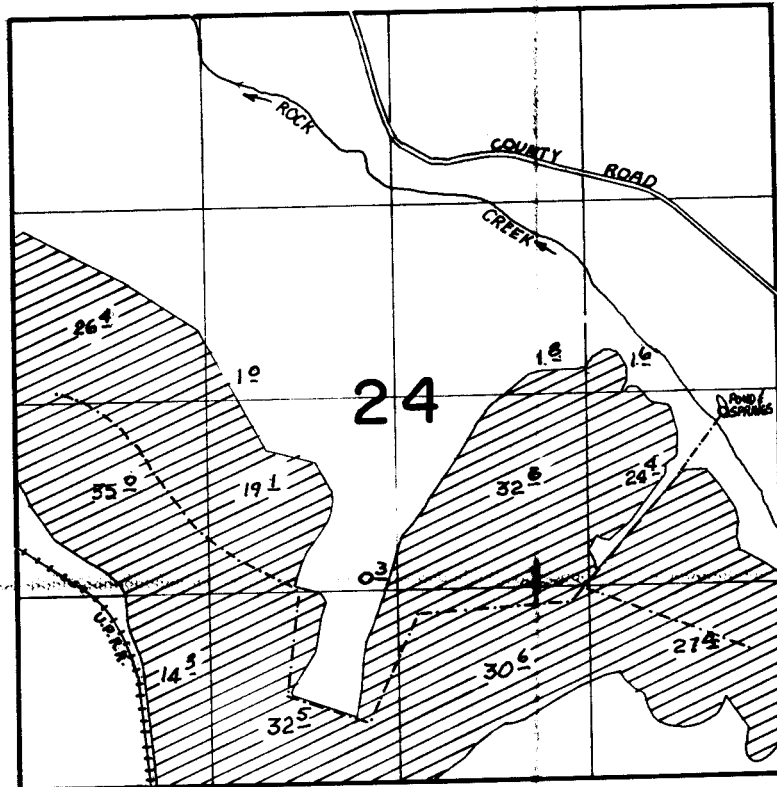
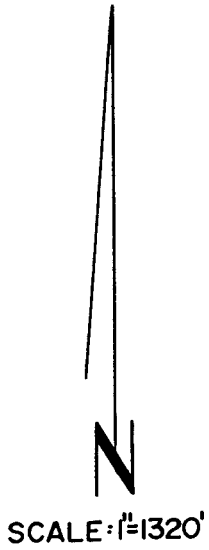

DIV. PT. LOCATED 2500' N. AND 380' W. FROM SE. COR. SEC. 24

FINAL PROOF SURVEY UNDER

Application No. G-9072. Permit No. G-8544.....
IN NAME OF

.....TIMOTHY R. MARICK.....

Surveyed MAY 9..... 1985., by V.L. CHURCH.....