

T.8S., R.40E., W.M.

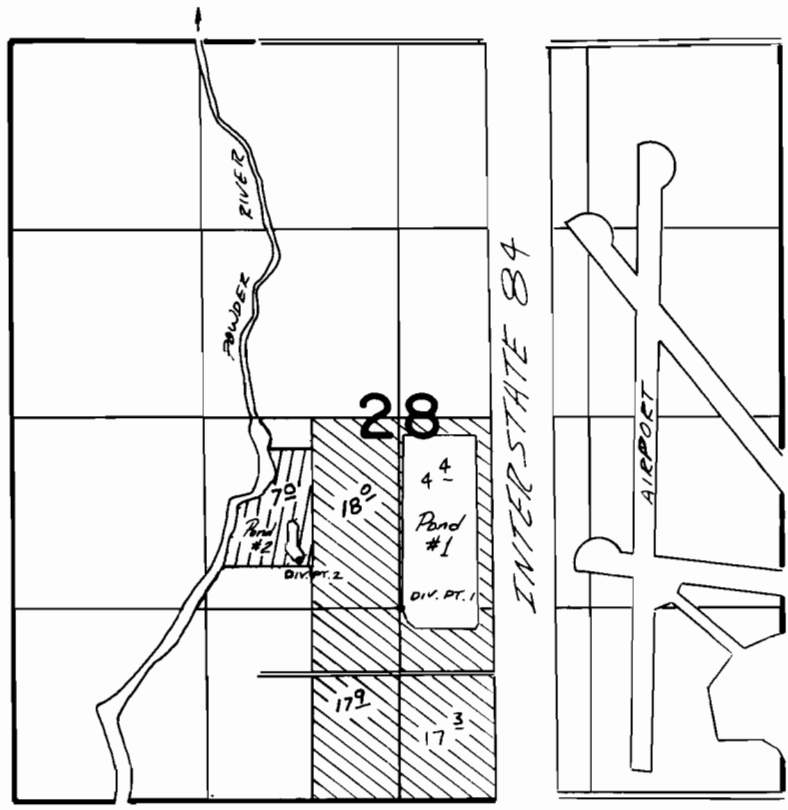

Div. Pt. 1 Loc: 1320' N. From S 1/4 Cor. Sec. 28
Div. Pt. 2 Loc: 1650' N. & 690' W. From S 1/4 Cor. Sec. 28

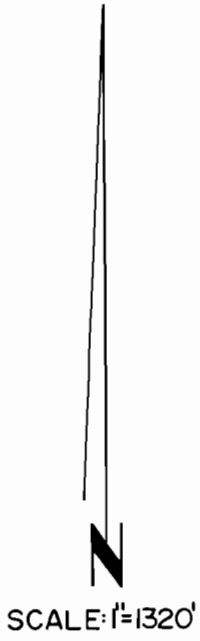
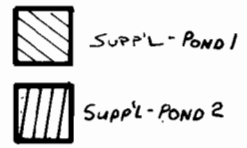

FINAL PROOF SURVEY
UNDER

Application No. **G-9347** Permit No. **G-8769**
IN NAME OF

ROBERT L. BLACK

Surveyed *DEC. 11, 1981*, by *V.H. Church*