

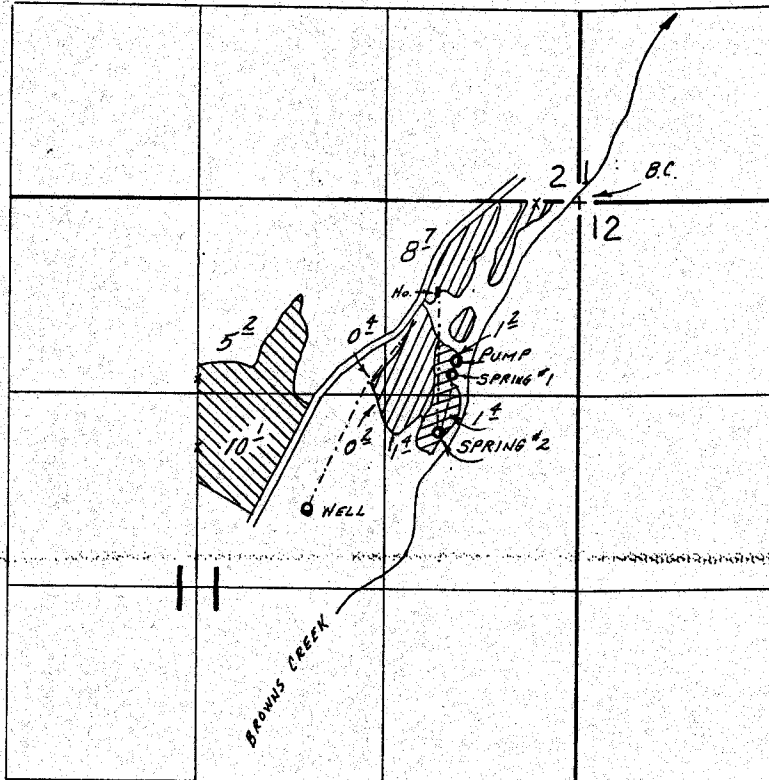



T. 1 N., R. 12 E., W.M.



SCALE: 1" = 1320'

SPRINGS LOC. 1-1180'S & 880' W., 2-1570'S. & 960' W.; WELL LOC. 2090' S & 1870' W. ALL FROM THE NE COR. SEC. 11.

-  Supplemental G-10110 & 50491
-  Primary 50491 Supplemental G-10110
-  Primary G-10110

FINAL PROOF SURVEY UNDER

G-10110 G-9185
 Application No. 50491... Permit No. 38128.....
 IN NAME OF

ALBERT R. WASSON

Surveyed Jan. 10, 1983, by T. J. PAUL