

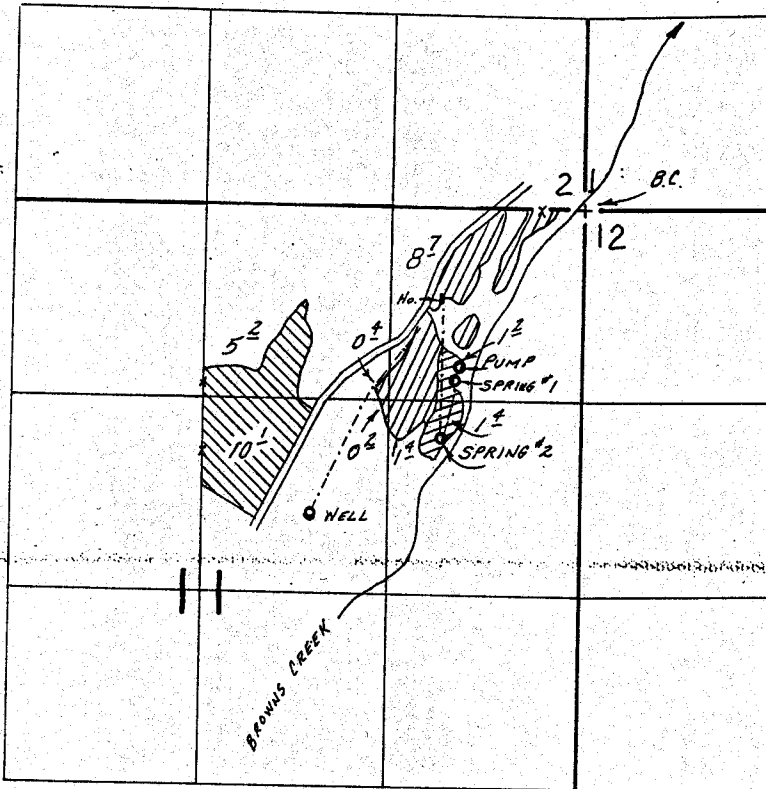



T. 1N., R. 12E., W.M.



SCALE: 1" = 1320'

SPRINGS LOC. 1-1180'S & 880'W., 2-1570'S. & 960'W.; WELL LOC. 2090'S & 1870'W. ALL FROM THE NE COR. SEC. 11.

-  Supplemental G-10110 & 50491
-  Primary 50491 Supplemental G-10110
-  Primary G-10110

**FINAL PROOF SURVEY**  
UNDER

G-10110                      G-9185

Application No. 50491... Permit No. 38128.....

IN NAME OF

ALBERT R. WASSON

Surveyed Jan. 10... 19.83, by T. J. PAUL.....

1/20/88 Bwb  
41065-179-232L