

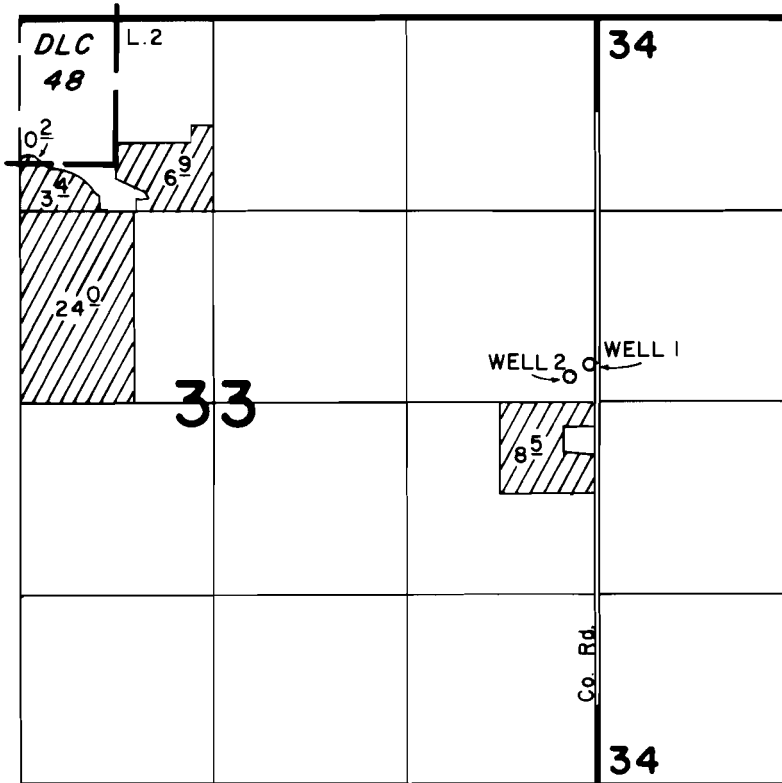

T. 3 S., R. 1 W., W.M.



WELLS LOC.: WELL 1 - 260' N. & 30' W., WELL 2 - 150' N. & 190' W.,
BOTH FROM THE E. 1/4 CORNER SECTION 33.

FINAL PROOF SURVEY UNDER

Application No. G-11637 Permit No. G-10851...
IN NAME OF

KLUPENGERS NURSERY & GHSE., INC.

Surveyed MAY 21, 1990, by T. M. WARREN.

178
3340
6401