

T.30S., R.3W., W.M.

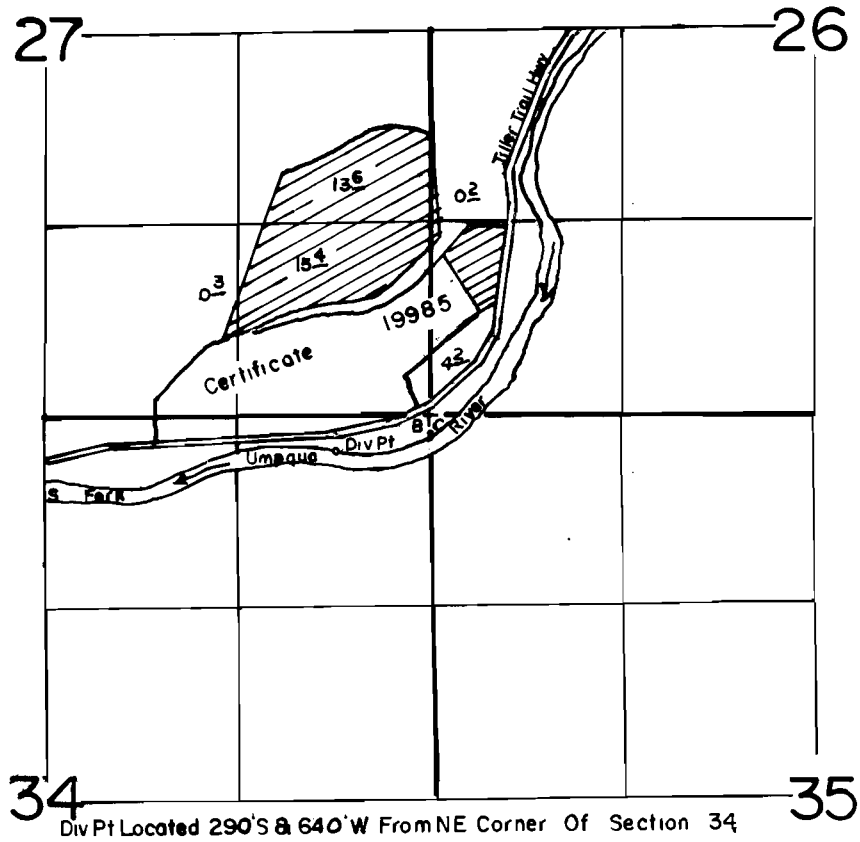

SCALE: 1"=1320'

**FINAL PROOF SURVEY
UNDER**

Application No. 52231.. Permit No. 39316.....
IN NAME OF

H.O. CARR Jr. & WANDA L. CARR.....

Surveyed MARCH.27 19.90., by B.S. JAMES.....