

T. 8S., R. 38E. W.M.

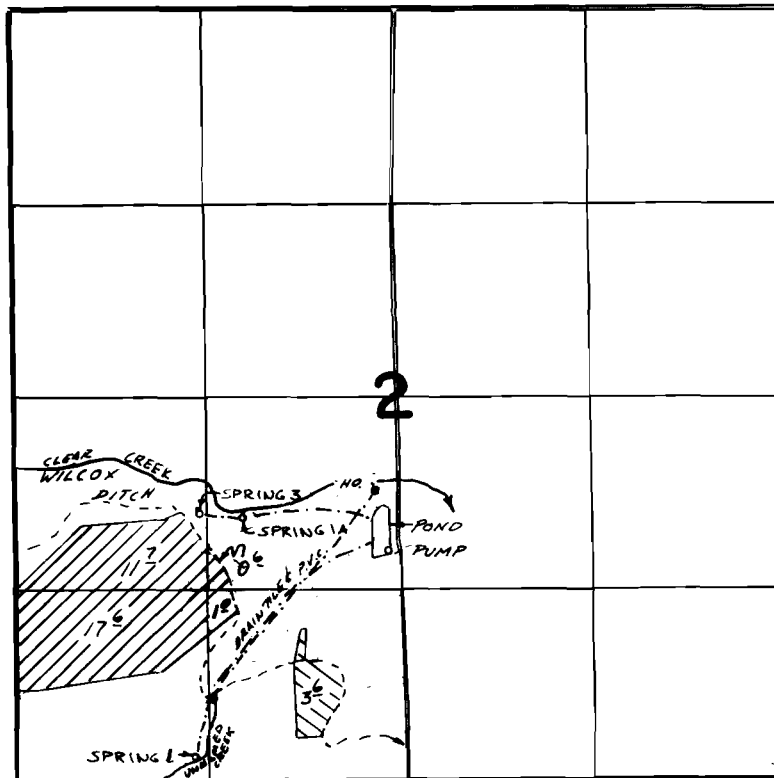

SPRING 2 LOCATED 1810' N. / 1550' E. FROM SW COR. SEC. 2
 SPRING 1. LOCATED 160' N. / 1230' E. FROM SW COR. SEC. 2
 SPRING 3 LOCATED 1850' N. / 1370' E. FROM SW COR. SEC. 2
 PUMP LOCATED 1580' N. / 2550' E. FROM SW COR. SEC. 2



PRIMARY



SUPPLEMENTAL

FINAL PROOF SURVEY
 UNDER

Application No. **55630** Permit No. **42717**.....
 IN NAME OF

DEPARTMENT OF FISH AND WILDLIFE...

Surveyed **4-14** 19**82**, by **V. CHURCH**...