

SOUTHERN PACIFIC RAILROAD

40 Line 7

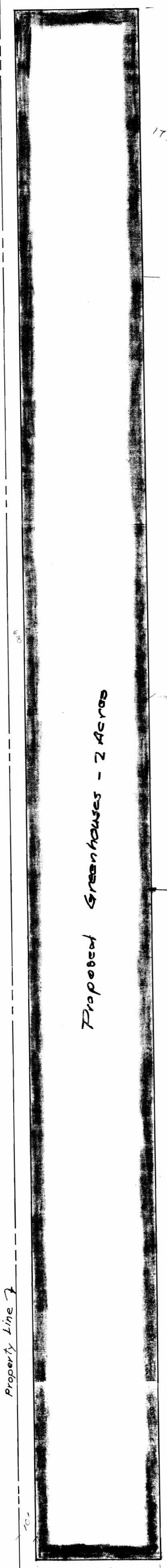

Proposed Greenhouses - 2 Acres

M.H.

Hot water pipe line

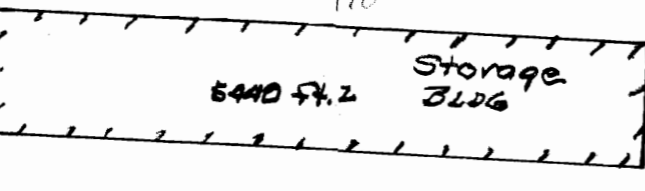

M.H.

Proposed Pipe
2-3" Pipes
Supply & Return

Point of Diversion

HOT WATER SUMP
WITH HEAT EXCHANGER

Pump

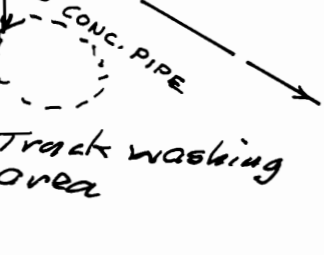

2-3" Pipes
Supply & Return
City water

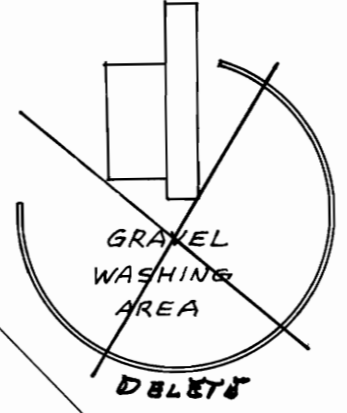

Aggregate Storage Area

N 42° 30' W ~ 1100 S

SOUTH SIXTH STREET

PAVED STREET

DATSUN
DEALER
BLDG.
10,800 sq. ft.

Office
C.R.I.
CONCRETE
PLANT
4 Stories
64,000 sq. ft.

FLOOR
C.R.I.
SHOP

47084

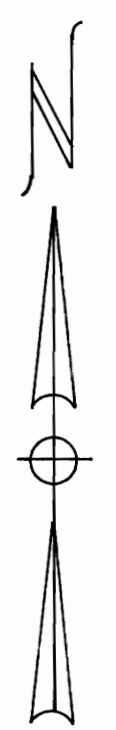

Property Line

740'

1/4 Corner Sec. 33

33
4

RECEIVED
OCT 1 1982
WATER RESOURCES DEPT.
SALEM, OREGON

RECEIVED
JUL 15 1982
WATER RESOURCES DEPT.
SALEM, OREGON

Rev. 10/8/82 #10/8/82

MAP SHOWING GEOTHERMAL WATER USE
FOR
STILES ENTERPRISES, INC.
IN SE 1/4 SW 1/4 SEC. 33, T. 38 S., R. 9 E., W.M.
KLAMATH COUNTY, OREGON
Scale: 1" = 50'
Map prepared by: **WILLIAM L. WALES
& Associates**
Consulting Engineers
1740 Austin Street
Klamath Falls, Oregon
July, 1982

