

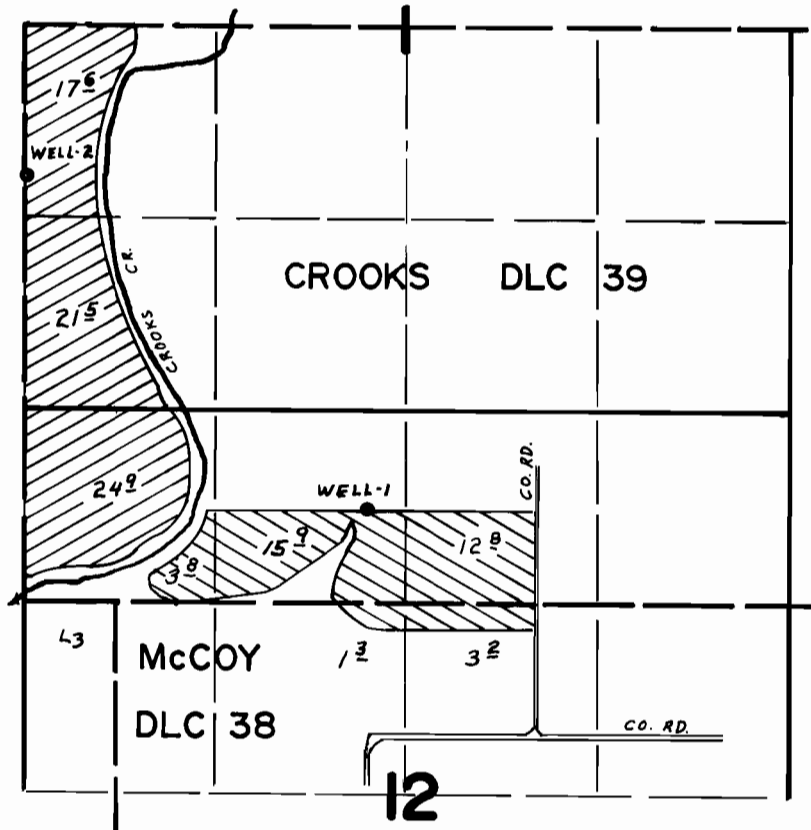

T.10S. R.4W., W.M.



Wells Loc. 1 - 680'S. & 2350' E. Both From N.W. Cor. Sec. 12
 2 - 1600' N. & 10' E.

 Well - 1
 Well - 2

FINAL PROOF SURVEY UNDER

Application No. G-7992... Permit No. G-7414...
 IN NAME OF

.....BURNEL HARNISCH.....

Surveyed APR. 19... 1978, by S. P. APPLGATE