

T. 28 S., R. 5 W., W. M.

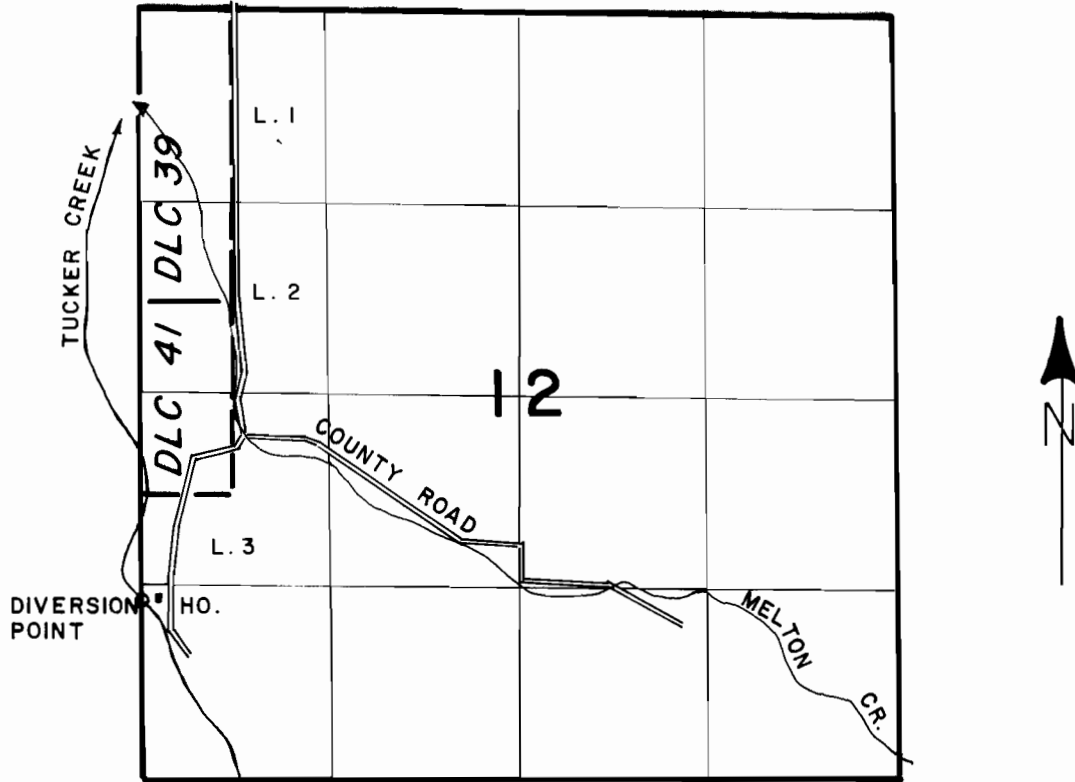

DIVERSION POINT IS LOCATED 1240 FEET NORTH AND 10 FEET EAST FROM S.W. CORNER SECTION 12.

SCALE: 4" = 1 MILE

FINAL PROOF SURVEY UNDER

Application No. 68306 Permit No. 49273
IN NAME OF

LENORA HELIAS

Surveyed JAN. 8 1988, by J.M. SCHMORDE.