

P-44612

T.13 S., R.31 E., W.M.

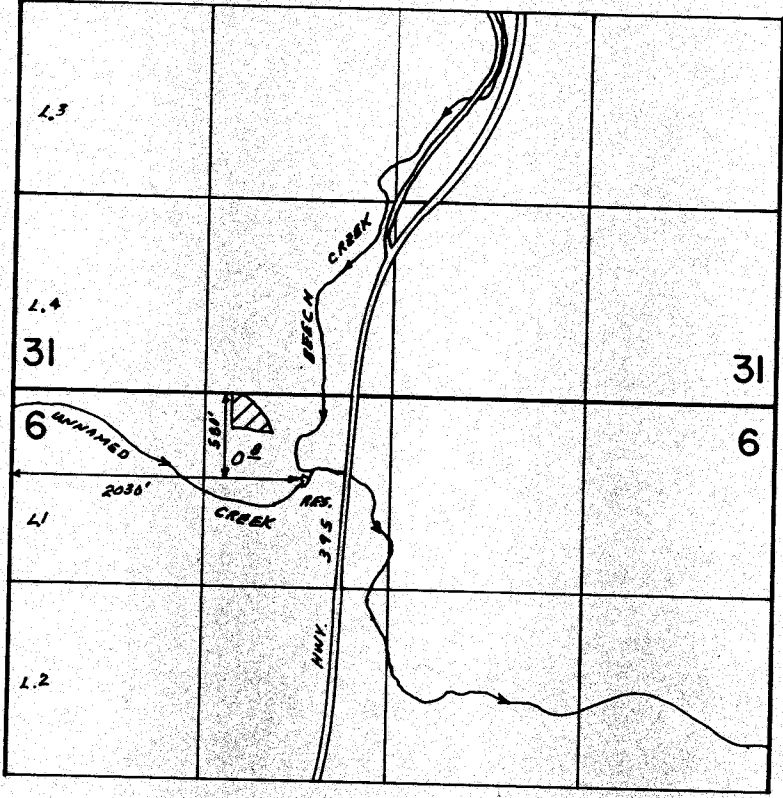

SCALE: 1"=1320'

PERMIT 44612 PRIMARY

PERMIT 46920 SUPPLEMENTAL STORED WATER ONLY

**FINAL PROOF SURVEY**  
UNDER

59359                      44612  
R63312                    R8478  
Application No. 63313    Permit No. 46920

IN NAME OF

**WILLIAM H. & YVONNE I. DOTSON**

Surveyed JUN. 16. 1988., by V.L. CHURCH.....

4/28/89  
d.d.c.