

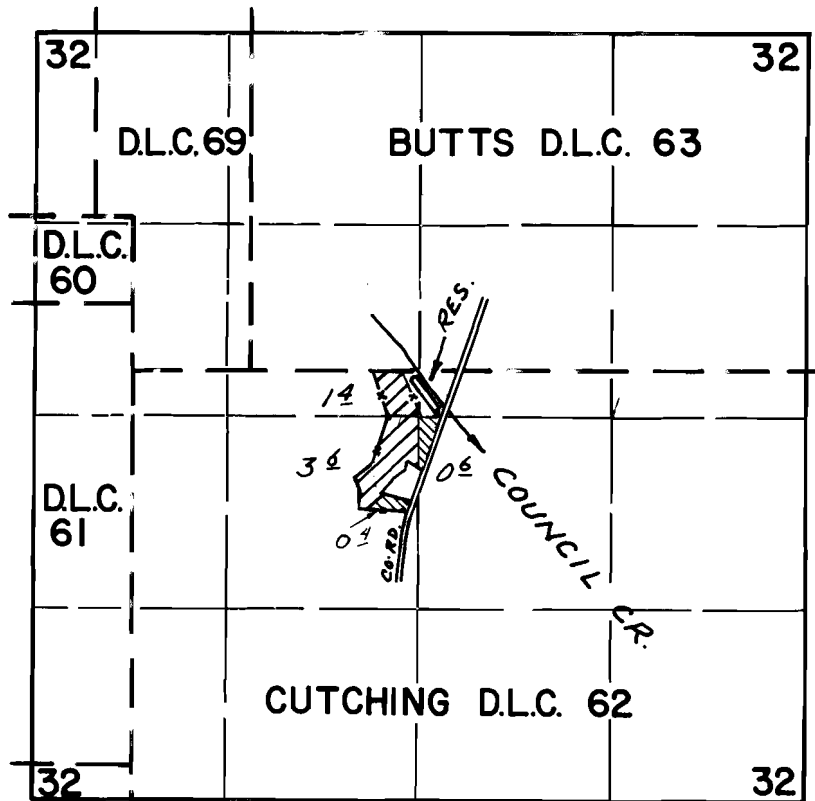

# T.I.N.R.3W.W.M.



DIV. PT. LOC: 230'S. & 2120'E. FROM N.W. COR.  
CUTCHING D.L.C. 62

## FINAL PROOF SURVEY UNDER

 SUPPLEMENTAL  
 PRIMARY

Application No. *R-52861* Permit No. *R-6122*  
*52862* *37828*  
IN NAME OF

*JOHN M. NUGENT*

Surveyed *MAY 1, 1979*, by *R.G. MUCKEN*