

T.I.N.R.3W.W.M.

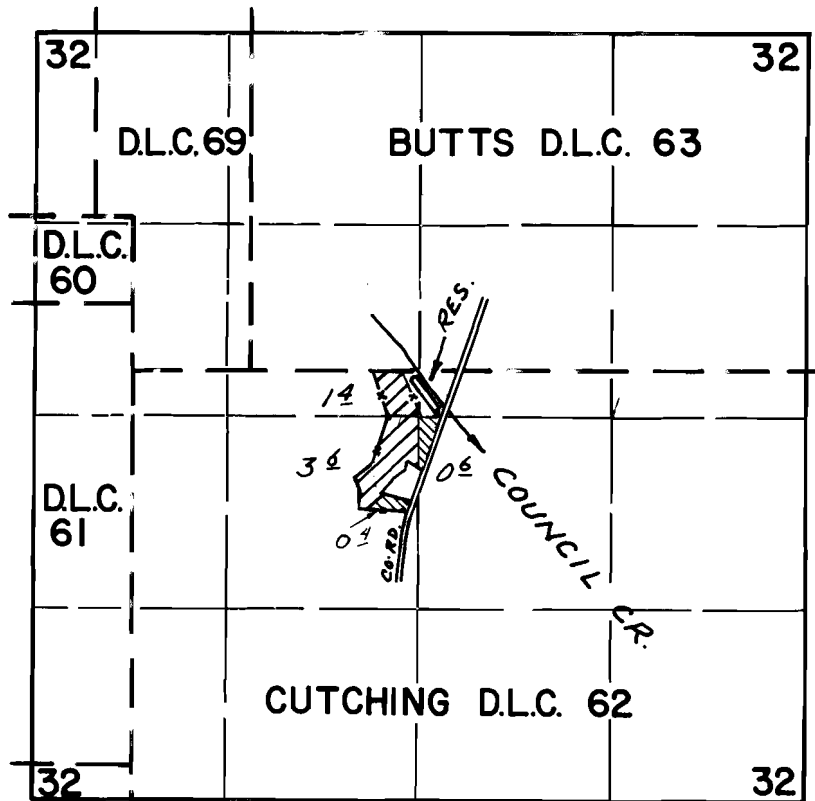

DIV. PT. LOC: 230'S. & 2120'E. FROM N.W. COR.
CUTCHING D.L.C. 62

FINAL PROOF SURVEY

UNDER

 SUPPLEMENTAL

 PRIMARY

Application No. *R-52861* Permit No. *R-6122*
52862 *37828*

IN NAME OF

JOHN M. NUGENT

Surveyed *MAY 1, 1979*, by *R.G. MUCKEN*