

T. 37 S., R. 5 W., W. M.

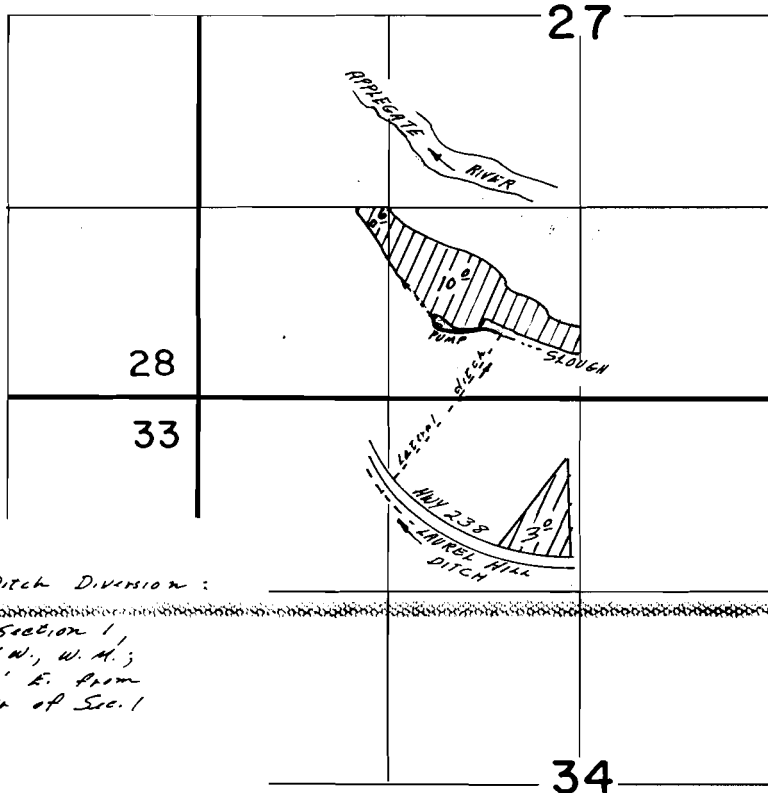

Laurel Hill Ditch Diversion:
 SW 1/4 NE 1/4, Section 1,
 T. 38 S., R. 5 W., W. M.;
 125' N., 500' E. from
 Center Corner of Sec. 1

Scale: 1" = 1320'

T 38S, R 5W, WM.

FINAL PROOF SURVEY UNDER

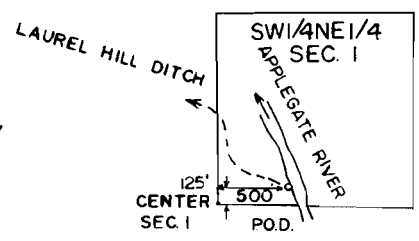

Application No. ~~63232~~ 63232. Permit No. ~~46723~~ 46723...
 IN NAME OF

APPLEGATE VALLEY RANCH

Surveyed APR. 5, 1988, by L. M. JOACHIMS