

T. 40S., R. 19E., W.M.

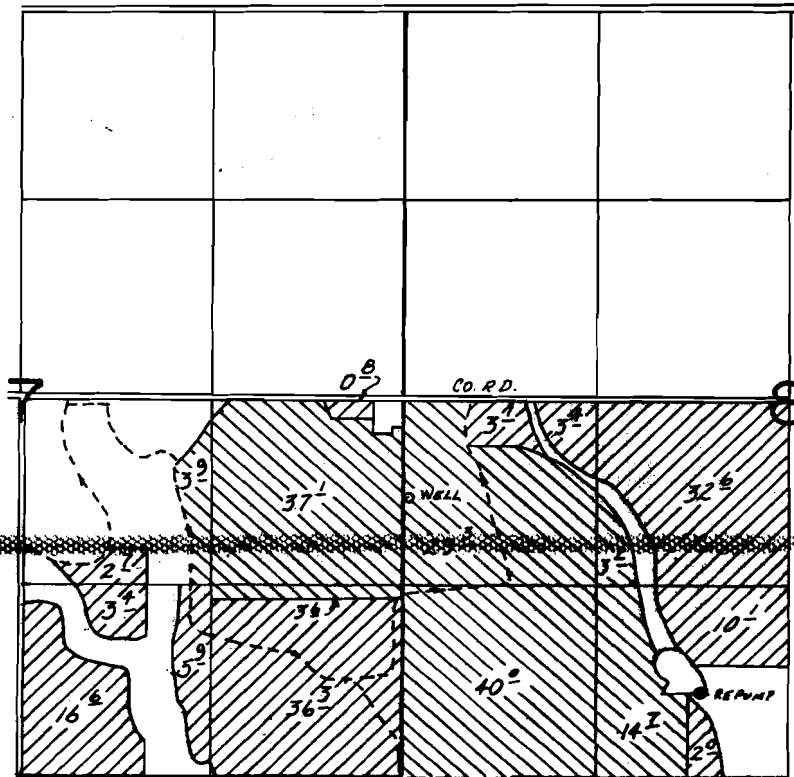

WELL LOC.: 680'S. & 30'E. FROM N. 1/4 COR. SEC. B.



PRIMARY
SUPPLEMENTAL

SCALE: 1"=1320'

FINAL PROOF SURVEY UNDER

Application No. G-8382.. Permit No. G-8598.....
IN NAME OF

.....HERBERT S. STOVER.....

Surveyed JUNE 26 1984, by B.W. BISHOP.....