

# T. 28 S., R. 13 W., W. M.

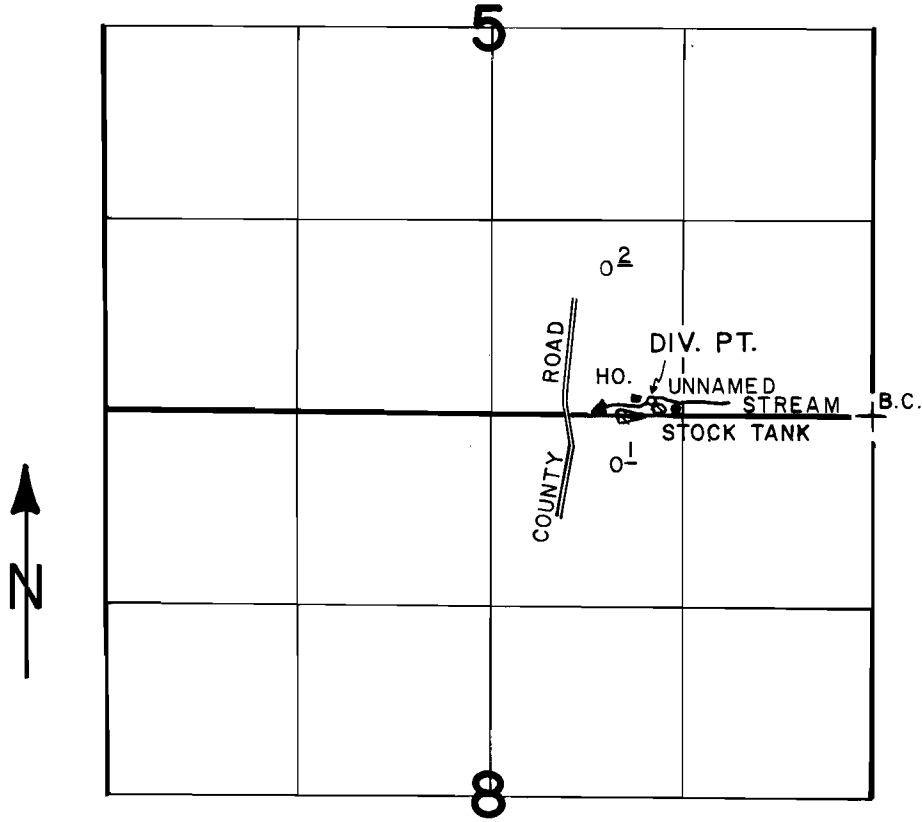

DIV. PT. IS LOCATED 100' N. & 1530' W. OF NE. COR. SEC. 8.

SCALE: 4" = 1 MILE

## FINAL PROOF SURVEY UNDER

Application No. 57441 Permit No. 43288  
IN NAME OF

**BUCKLEY L. & VIRGINIA C. OGDEN**

Surveyed SEPT 10, 1985, by J. M. SCHMORDE