

T. 33 S., R. 7 1/2 E., W.M.

45824
65857

Combed Creek & Misc.

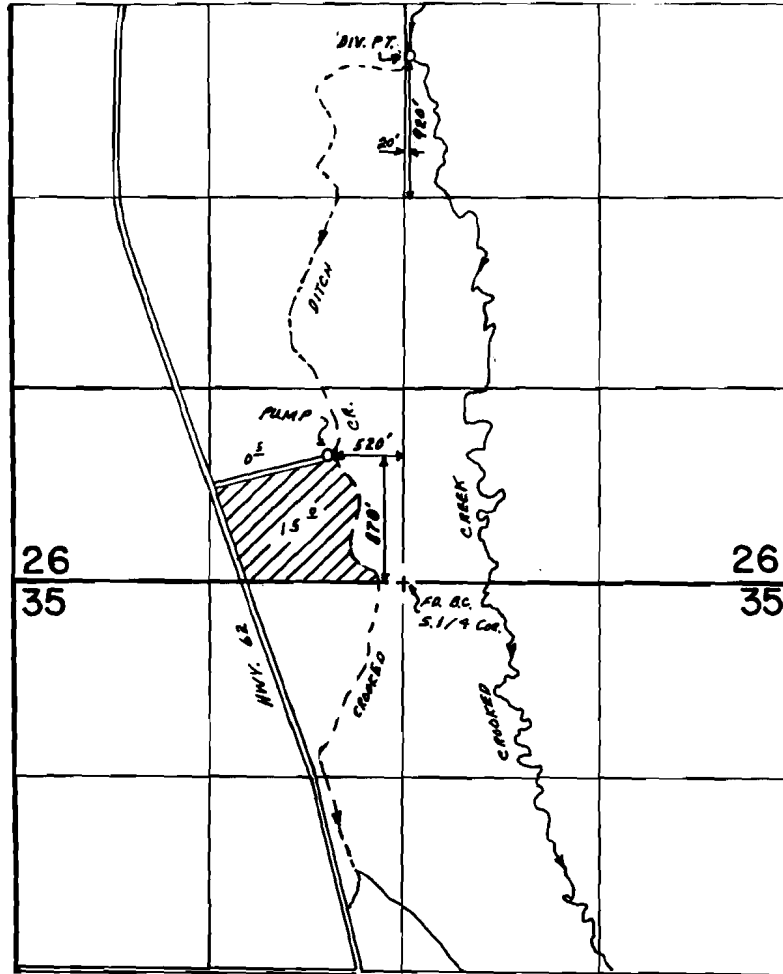

SCALE: 1"=1320'

FINAL PROOF SURVEY
UNDER

Application No. 61577... Permit No. 45826.....
IN NAME OF

LAWRENCE & ANN HALL

Surveyed AUG. 20, 1987, by M. SCHMORDE