

**T.37 & 38S., R.5W., W. M.**

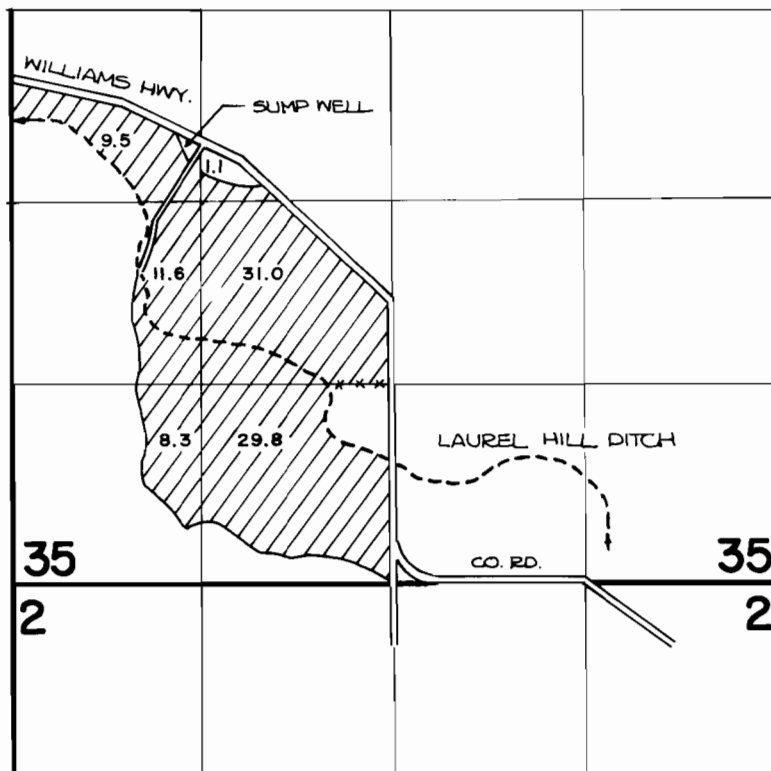

SUMP WELL IS LOCATED 310' N. AND 1400' W. FROM THE CENTER OF SECTION 35.

**FINAL PROOF SURVEY**  
UNDER

Application No. **G-7264** Permit No. **G-6660**  
IN NAME OF

.....**LYLE WOODCOCK**.....

Surveyed **APR. 28 1983**, by .....**B. JAMES**.....