

T. 4 S. R. 21 E. W.M.

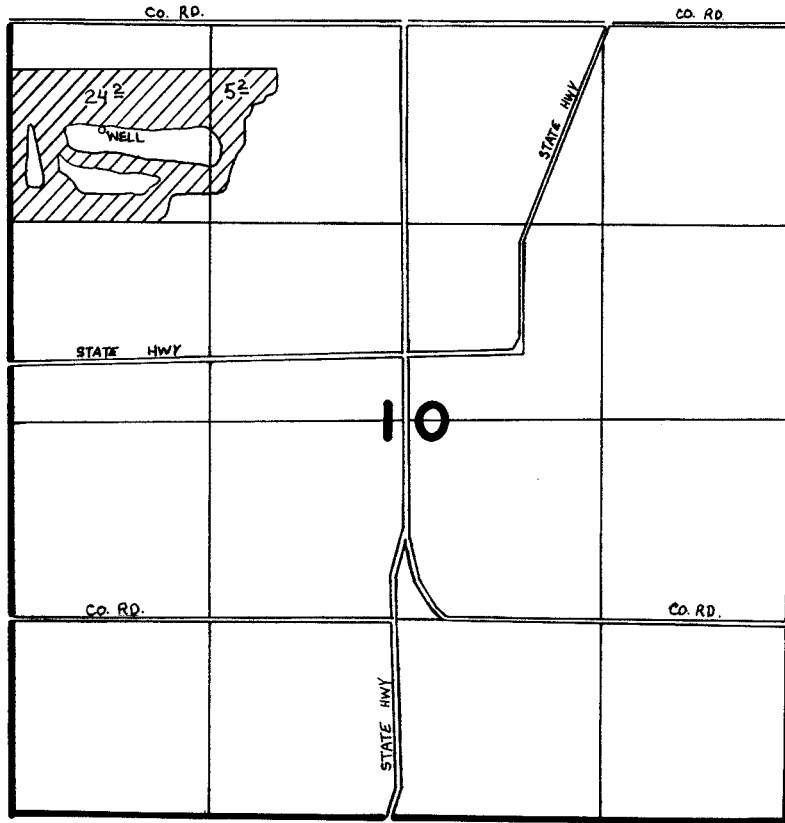

WELL LOC. 740' S. & 630' E. FROM N.W. COR. SEC. 10

FINAL PROOF SURVEY UNDER

Application No. G.7.535.. Permit No. G.7.Q.Q7.....
IN NAME OF

.....CITY OF CONDON.....

Surveyed May..15.. 1986., by V.Church.....