

65945

T. 40 S., R. 8 E., W.M.

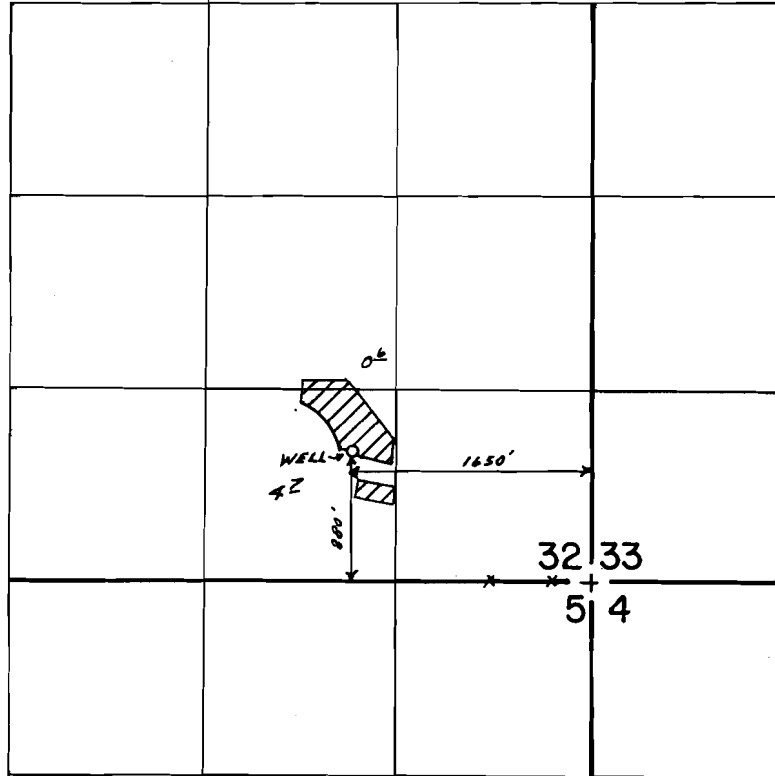

SCALE: 1"=1320'

FINAL PROOF SURVEY
UNDER

Application No. G-10277 Permit No. G-9330
IN NAME OF

PHILIP W. & DANNETTE D. HARTMAN

Surveyed AUG. 20, 1987, by B. BISHOP

3-13-89

A.L.C.

Hamath River Wells