

# T.15S., R.11E., W.M.

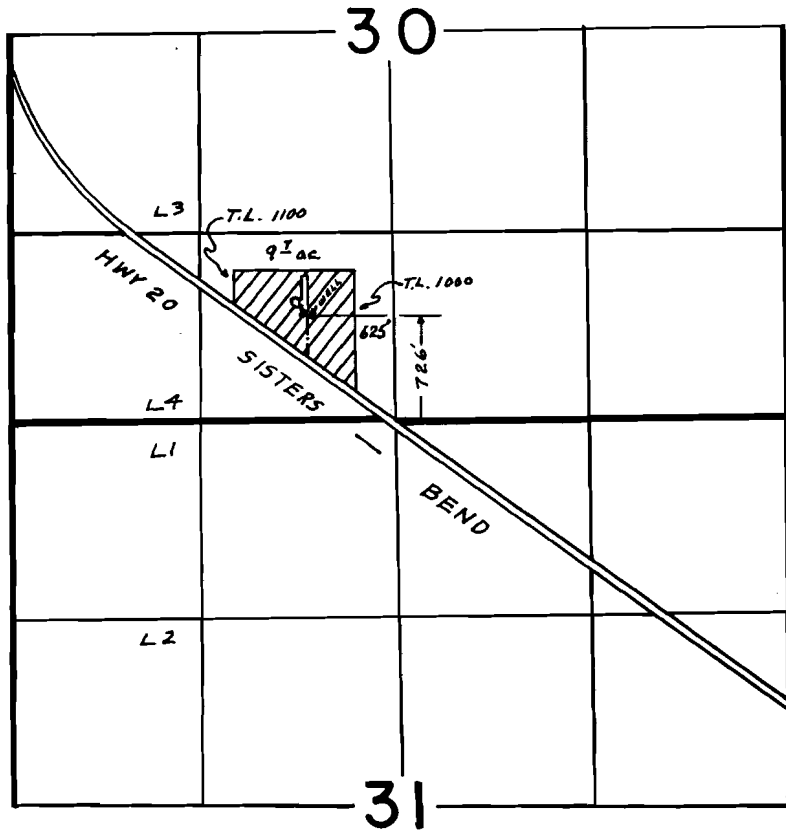

SCALE: 1" = 1320'

## FINAL PROOF SURVEY UNDER

Application No. G-11283. Permit No. G10463  
IN NAME OF

**MORRIS B. McGINNIS**

Surveyed NOV. 9 1987, by M. J. MATTICK.

Cert. #65972

G-10463

Rec'd 7-12-91 WD# 11