

T. 41 S., R. 4 E., W.M.

N

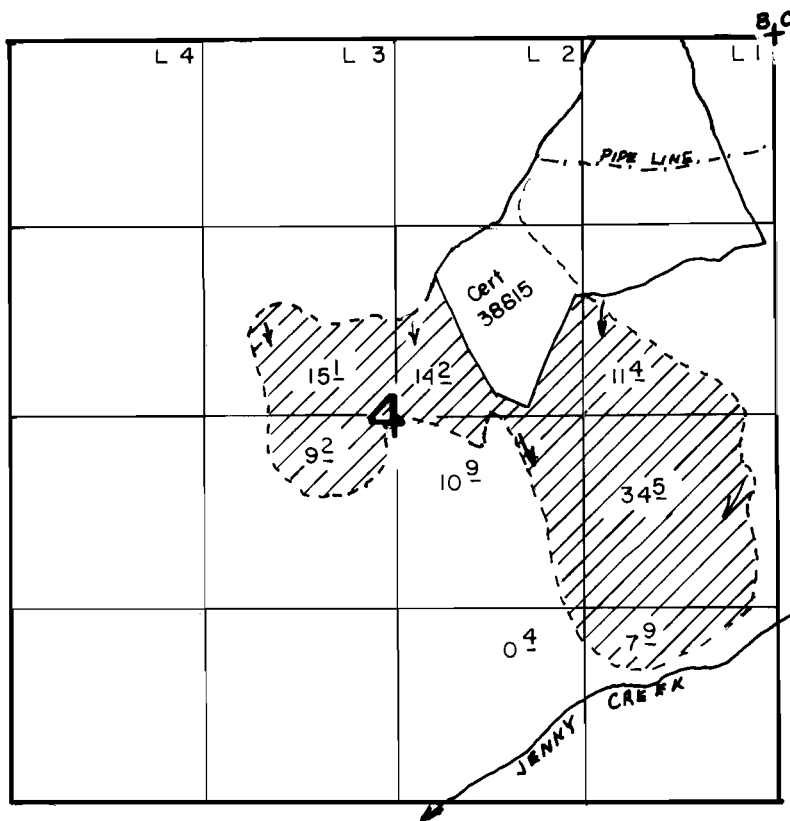

T 40 S., R 4 E., W M

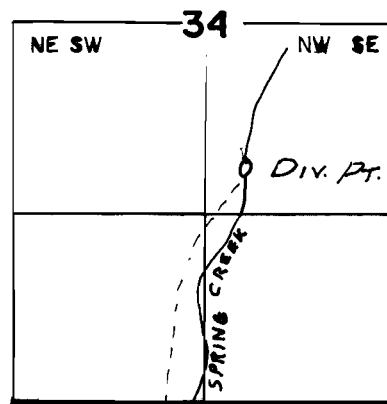

Div Pt Loc 1620' N & 260' E From SW 1/4 Cor Sec 34

**FINAL PROOF SURVEY**  
UNDER

Application No. 61307..... Permit No. 45923.....  
IN NAME OF

.....**CECILIA TAYLOR**.....

Surveyed AUG. 15... 1989., by .B.S. JAMES.....