

Permit 48537

Permit 41002 Primary

Permit 45905 Supplemental

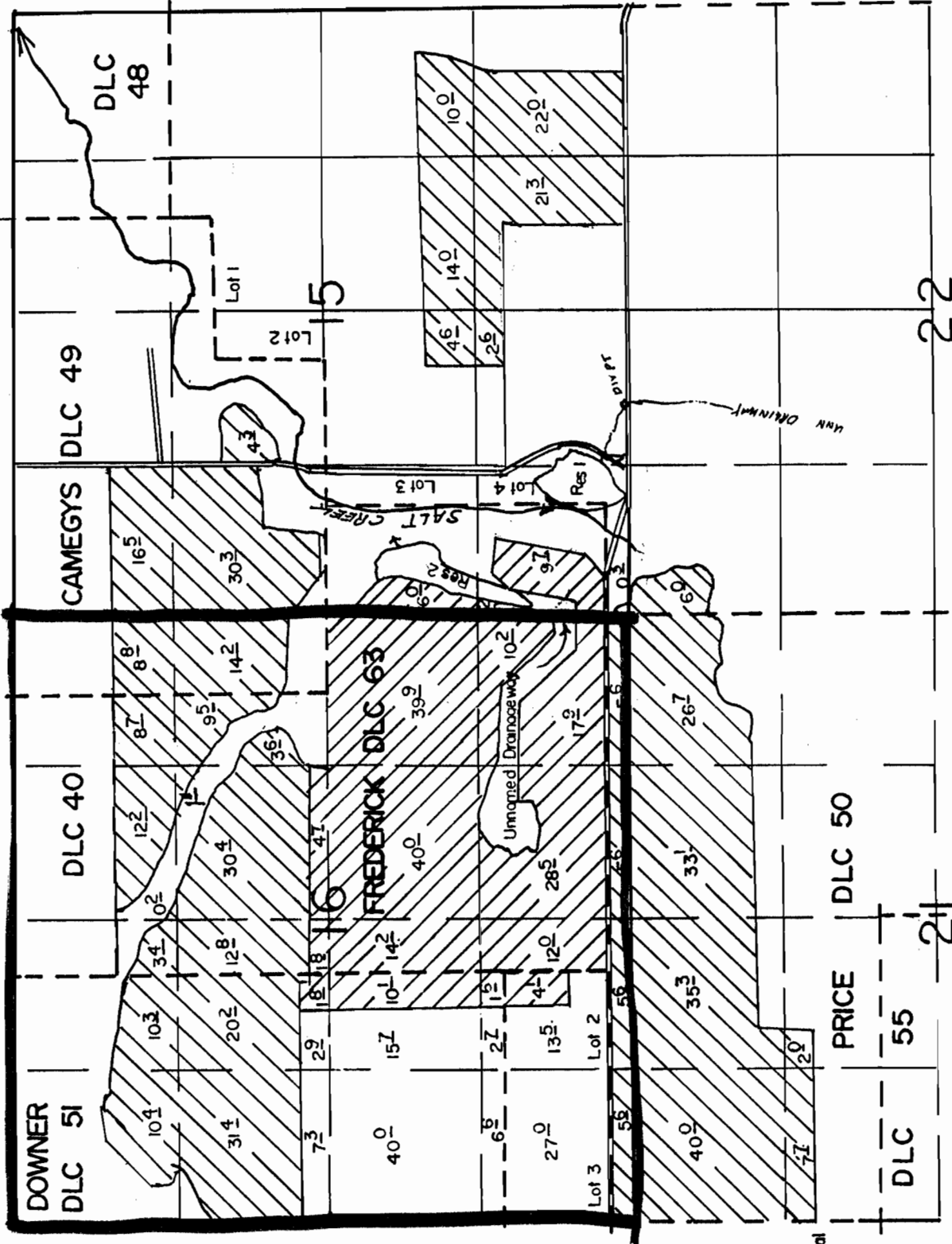

FINAL PROOF SURVEY

R-54768 UNDER R-6543
 54769 41002
 60494 45905
 Application No. 67548 Permit No. 48537

IN NAME OF
SCHARE FARMS

Div. Pts. Loc. Res No 1, 680' N & 1590' W From S1/4 Cor. Sec 15
 Res No 2, 1970' N & 600' E From SW Cor. Section 15

SCALE: 1" = 1320'

PRICE	DLC 50
DLC	55
	211

Application No. 67548
 Permit No. 48537

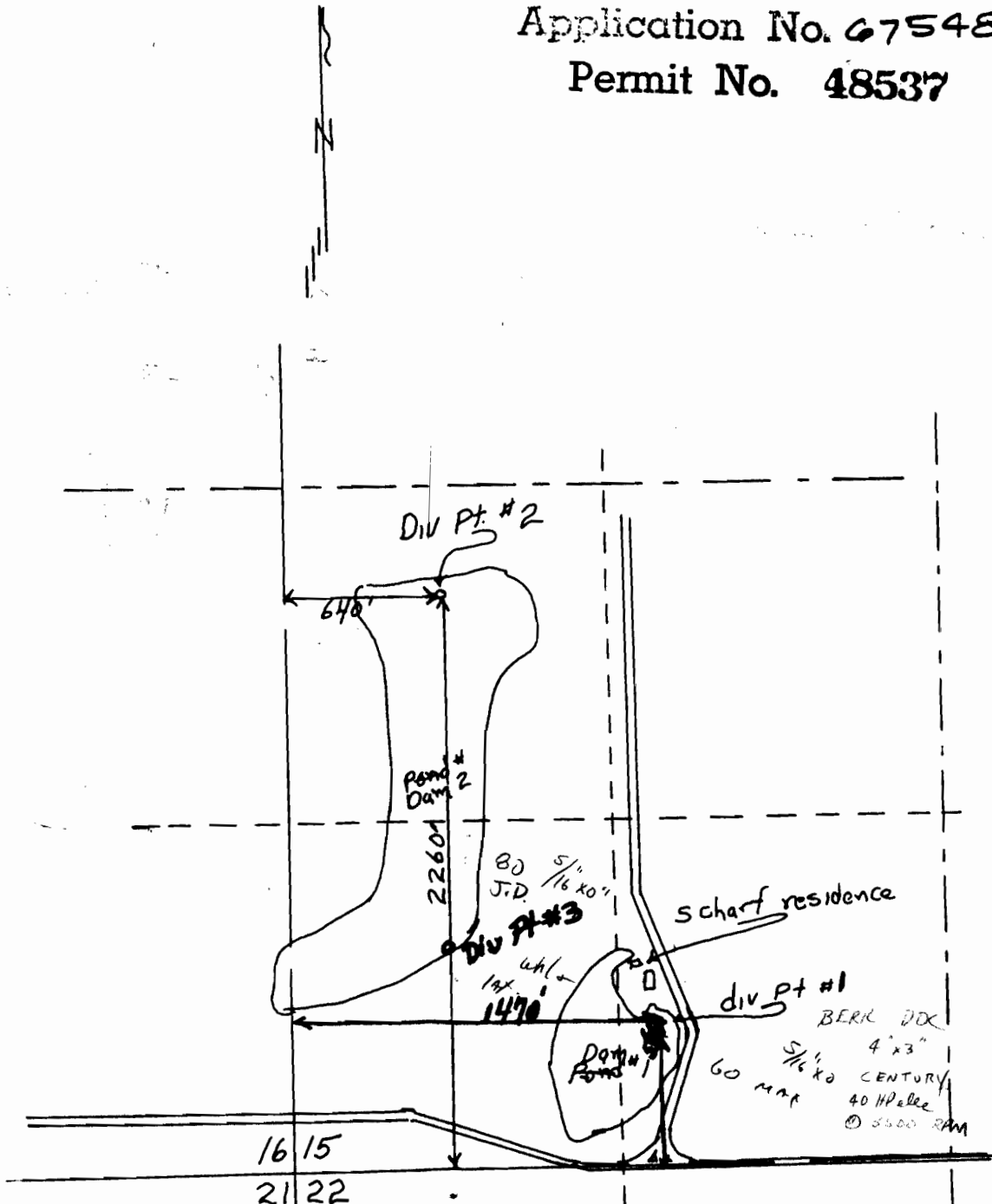

RECEIVED

MAY 22 1984
 WATER RESOURCES DEPT.
 SALEM, OREGON

RECEIVED

FEB 22 1984
 WATER RESOURCES DEPT.
 SALEM, OREGON

Robert E. Scharf
 T 6 S R 5 W
 Scale 1" = 660'

- Diversion point #1 = 560 ft N & 1,470 ft E from SW corner of Section 15.
- Diversion point #2 = 2,260 ft N and 640 ft E from the SW corner of Section 15.
- Diversion point #3 = 640 ft E and 863 ft N of the SW corner of Section 15.

INFO: John Scharf, use as applied. He has applied ~~for~~ ^{+ OVER REFERENCE} water from both ponds to all of acreage he asked for under this permit and his overacreage he intends to apply on at a later date. ~~This permit~~ Irrigation under this permit is entirely on grass seed and he states he only irrigates entire acreage on average once every 3 years.

Source: Two ponds, constructed under P# R-5319; ^{one} and one constructed under P# R-6543.

PUMPS: POND #1
BERK DOC
4" x 3"

POND #2
UNKNOWN
DOC 6" x 4"

STORED
WATER
ONLY

MOTORS: CENTURY 60 HP
elec. @ 3450 RPM

JOHN DEERE
80 HP DIESEL

↓
MAX FROM
THIS PUMP
60 28 30's 5/16" x 10'

PIPE:
HOS: SEE F.P.
REPORT
FOR
APP# 54769 (ATTACHED)

USE: Irrigation of Grass for seed

LIFT: + 6' SUCTION BOTM; + 20' → - 5' DIS BOTM

TIE: 41053-178-212 D; 41053-178-212 A
+
PTS W/F.F

Thompson M. Warner
W.R.E. 6/30/89

T.6S. R.5 W. W.M.

Scharf Farms
by John Scharf,
partner

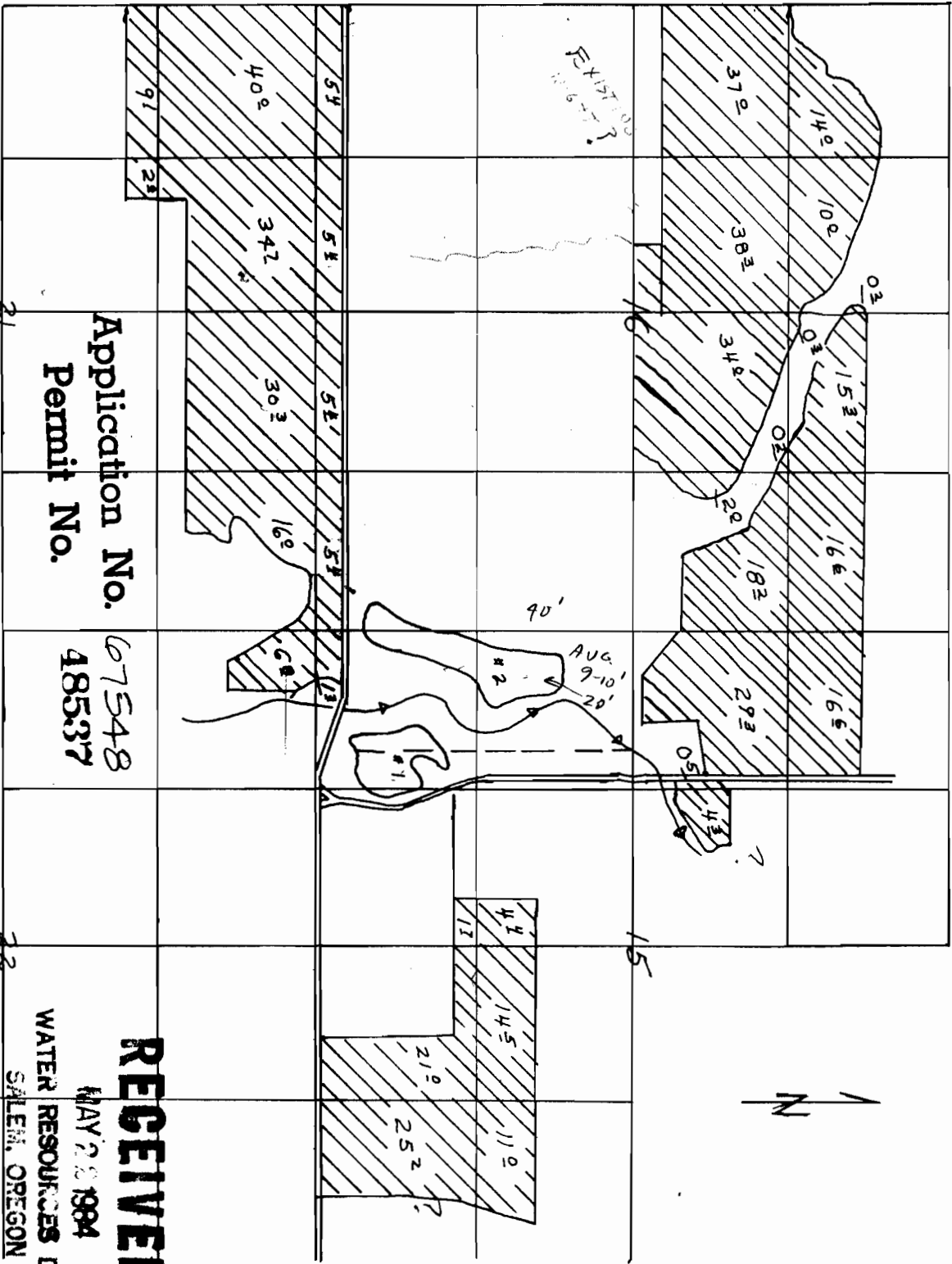

Application No. 67548
Permit No. 48537

RECEIVED

MAY 23 1984
WATER RESOURCES DEPT.
SALEM, OREGON