

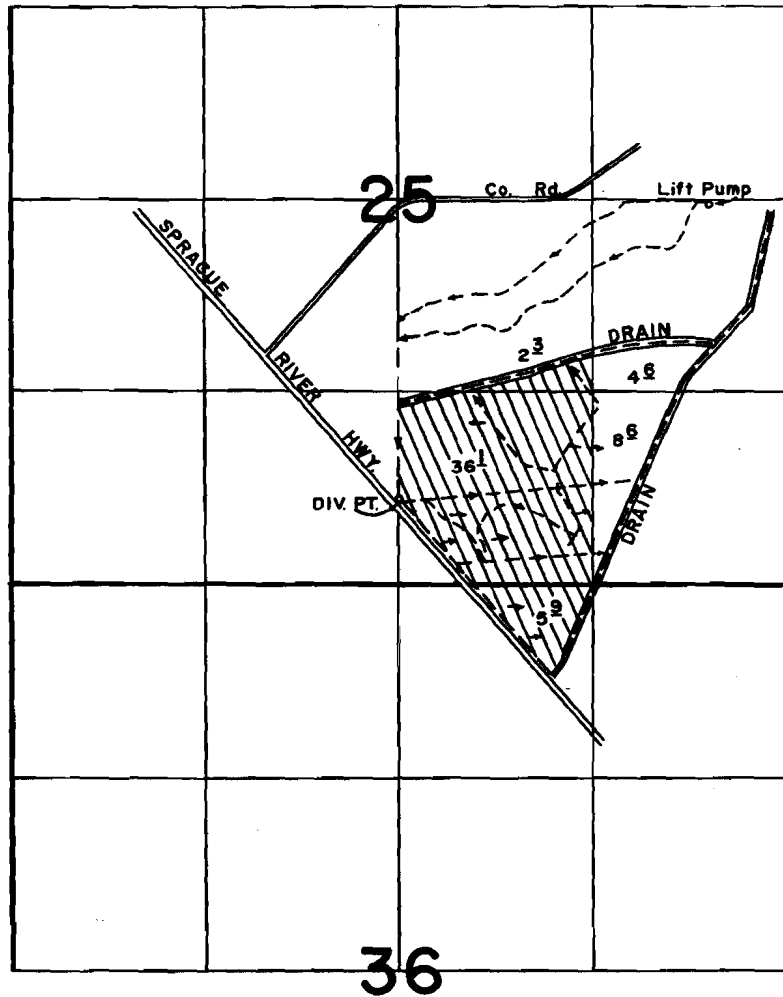

T. 36 S., R. 11 E., W.M.



N 315

Whiskey Creek & Mir.

DIV. PT. LOC.: 590' N. FROM THE S. 1/4 CORNER OF SECTION 25.

SCALE: 1" = 1320'

FINAL PROOF SURVEY UNDER

Application No. 67529.. Permit No. 48339.....
IN NAME OF

WILLIAM L. & NADINE F. GALLAGHER

Surveyed SEPT. 26 1989, by B. W. BISHOP...