

T.8S., R.47E., W.M.

T. 8 S., R. 46 E., W.M.

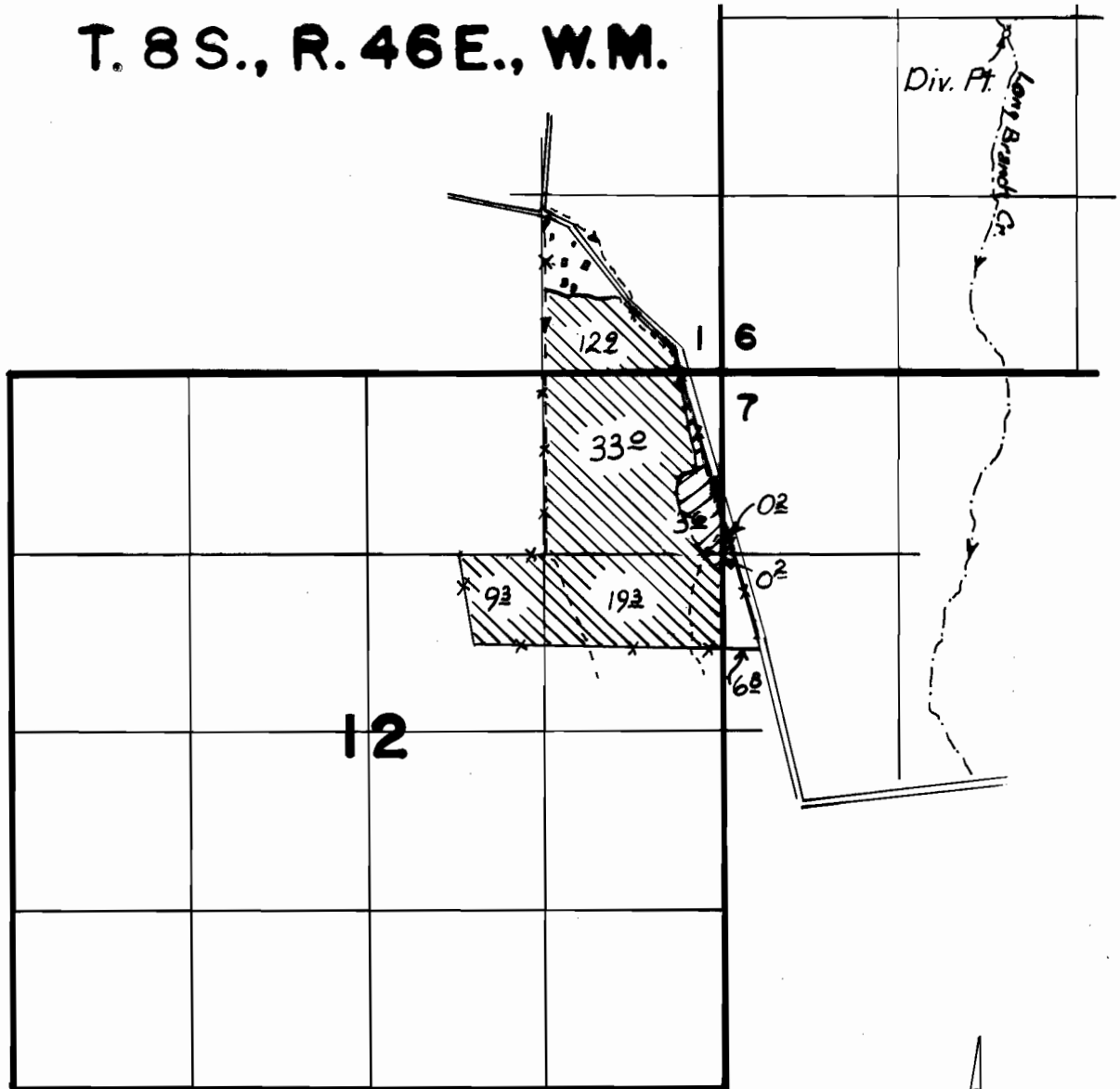

Location of div. pt. is 2500' N. & 2120' E. from the SW cor. of sec. 6, T. 8 S., R. 47 E.

FINAL PROOF SURVEY
UNDER

Scale 1" = 1320'

Application No. ~~68584~~ Permit No. 49591.....
IN NAME OF

DARRELL L. BIGELOW

Surveyed 8-24 1988, by Kenn Kemp

Primary



Supplemental

