

SPRINKLER SYSTEM OVERPAGE

WAREHOUSE 1	32,250 FT ²
POLE BLDG	18,190
WAREHOUSE 2	48,000
LOADING	10,800
WAREHOUSE 3	75,060
WAREHOUSE 4	54,148
WAREHOUSE 5	45,000
WAREHOUSE 6	44,100
WAREHOUSE 7	77,907
WAREHOUSE 8	239,880
STAGING	8,368
MIDWAY-TRUCK	23,141
PRODUCTION	105,696
TOTAL	776,540 FT²

INCLUDES SOME COVERED CANOPIES

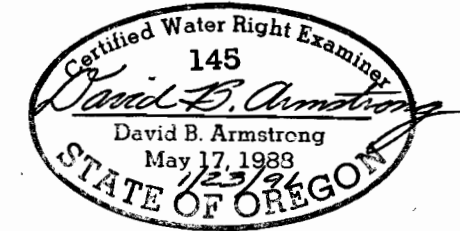

FINAL PROOF SURVEY MAP
FOR
LES SCHWAB WAREHOUSE CENTER, INC
LOCATED N SECTION 36, T.14S, R.15E AND IN SECTION 31, T.14S, R.16E AND IN SECTION 6, T.15S, R.16E, W.M., CROOK COUNTY, OREGON
WATER RIGHTS PERMIT NO. 50122
APPLICATION NO. 69311

APPLICANT
LES SCHWAB WAREHOUSE CENTER, INC.
P.O. BOX 667
PRINEVILLE, OREGON 97754
C 503 447-4136

C.W.R.E. FINAL PROOF SURVEY
DAVID B. ARMSTRONG, LICENSE 145
ARMSTRONG SURVEYING & ENGINEERING, INC.
378 EAST SECOND STREET
PRINEVILLE, OREGON 97754
C 503 447-7791

- LEGEND**
- PROPERTY LINE
 - - - FENCING
 - O.P.P. OVERHEAD POWER POLE
 - P OVERHEAD POWER LINE
 - ==== EDGES OF R.O.W.
 - 6" PVC 6" WATER MAIN - MUNICIPAL CITY OF PRINEVILLE
 - ◆ FIRE HYDRANT
 - ▲ SYSTEM CONTROL VALVE
 - FIRE SYSTEM WATER MAIN

SCALE
1" = 100'

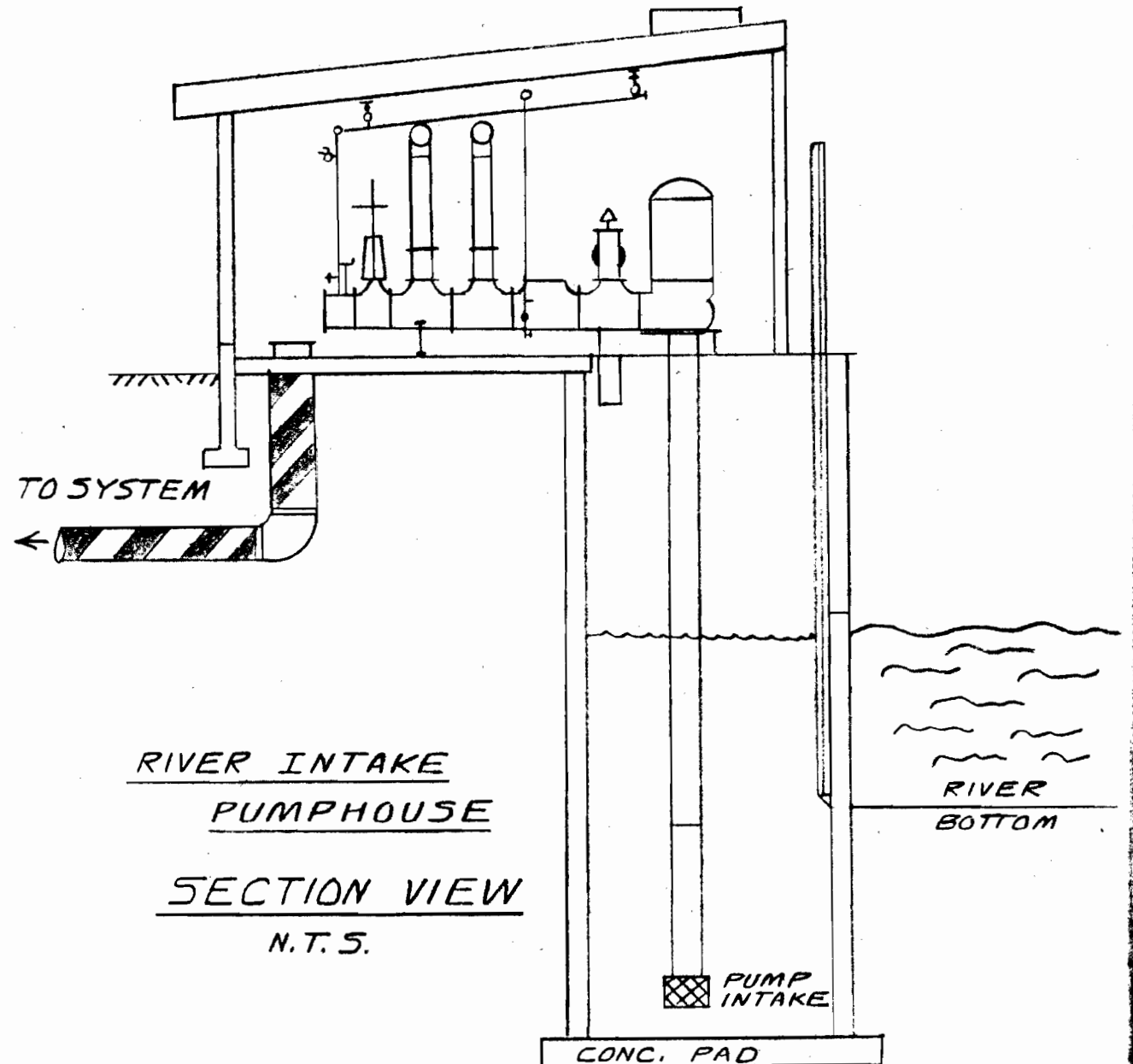
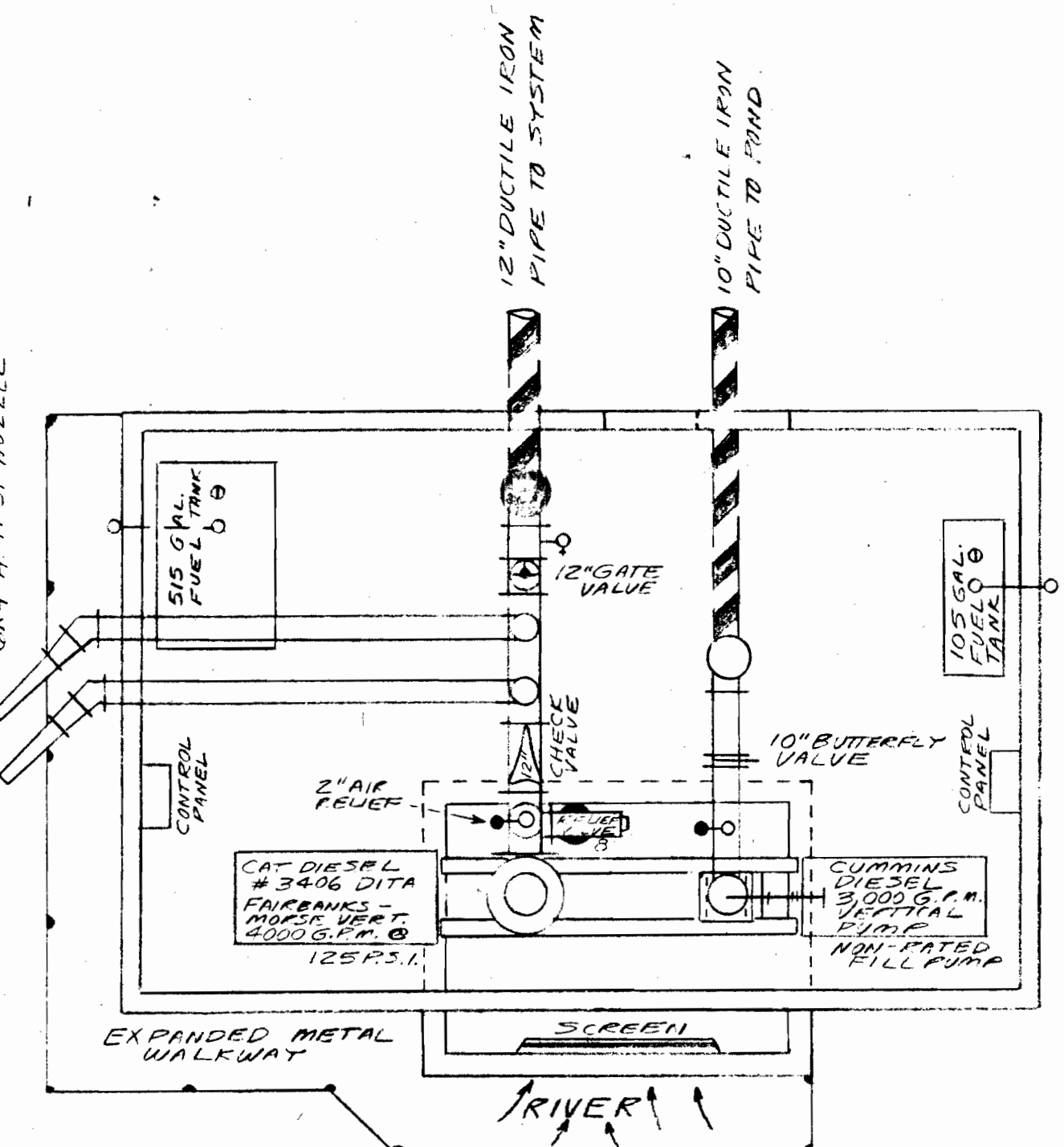
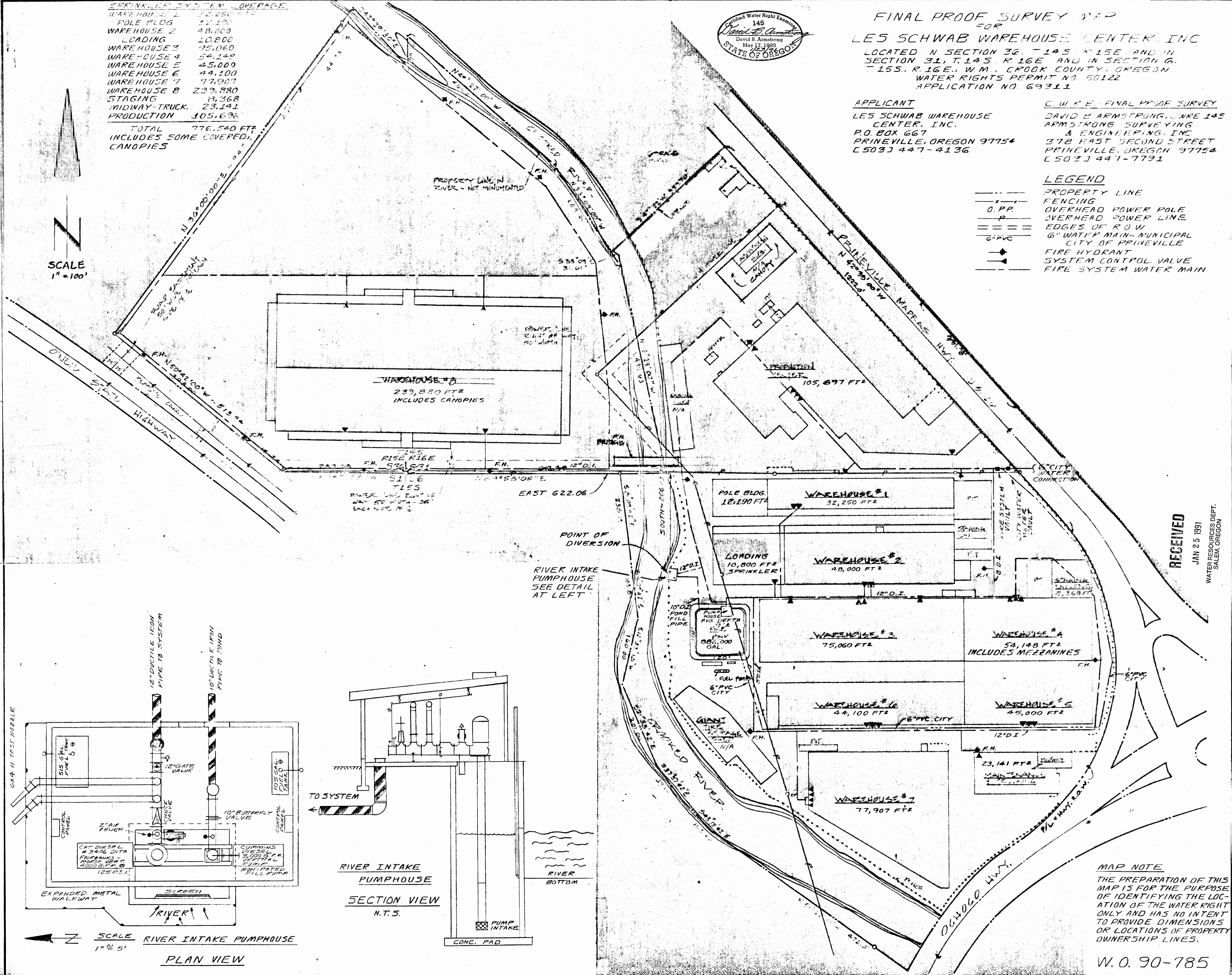

MAP NOTE
THE PREPARATION OF THIS MAP IS FOR THE PURPOSE OF IDENTIFYING THE LOCATION OF THE WATER RIGHT ONLY AND HAS NO INTENT TO PROVIDE DIMENSIONS OR LOCATIONS OF PROPERTY OWNERSHIP LINES.

RECEIVED
JAN 25 1991
WATER RESOURCES DEPT.
SALEM, OREGON