

T. 7 S., R 2 W., W.M.

SEC. 32

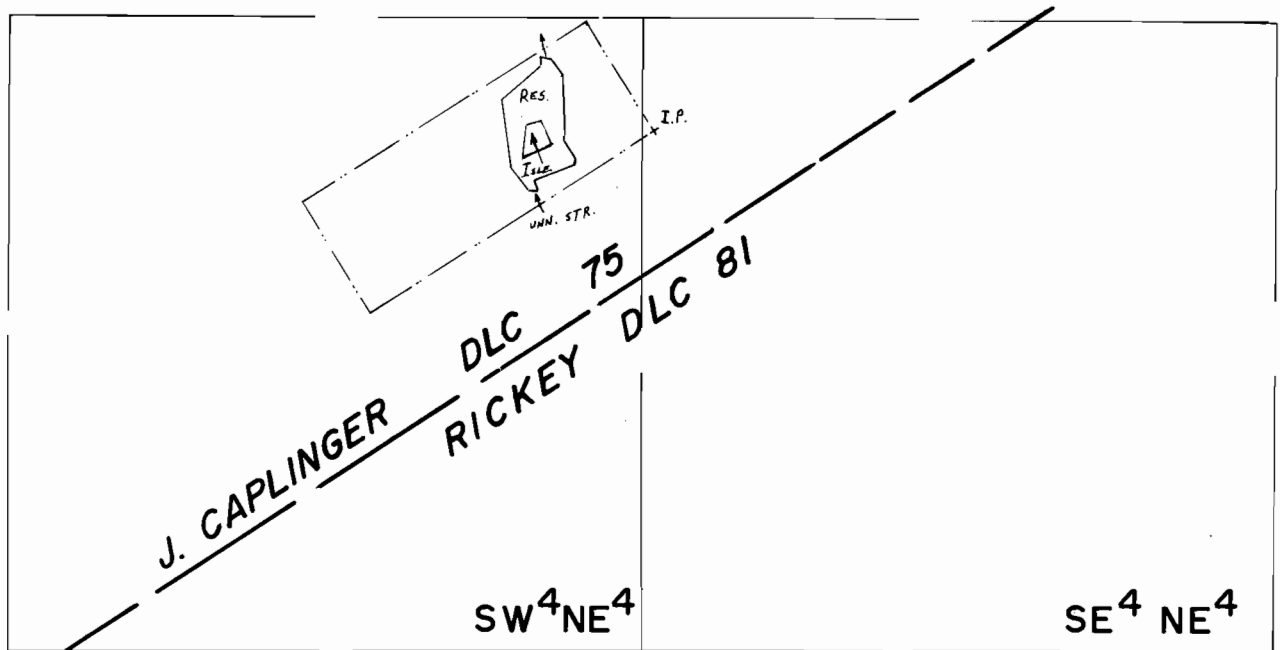

P.O.D. Loc. : 1235' N. & 1120' E. from C. 1/4 Sec. 32.

Scale: 1" = 400'

**FINAL PROOF SURVEY**  
UNDER

R- 68615                      R-10592  
Application No. 68616... Permit No. 49581.....

IN NAME OF

CLARK LEE CARPENTER

Surveyed Sept. 26. 1986., by T. Warren.....